

C530



C530
THE SPORTY CABRIOLET
FOR THE SEA.



SET OUT FOR THE SUNNY SIDE OF LIFE.



LARGE BATHING PLATFORM

Hydraulically operated and highly comfortable. The built-in steps unfold as the platform is lowered, providing a safe access to the sea.

OPEN AIR COCKPIT GRILL

Stay among your family and friends while cooking. With the smartly placed outdoor grill, fresh barbecued delights can be served directly from the bathing platform.

VERSATILE SEATING AREAS

The cockpit and bow area can be either prepared for seating or sunbathing. Enjoy two sundecks, two dining places or a mix of both possibilities.

UNIQUE DINETTE ON THE BOW

On the foredeck, you can find a separate dinette for entertaining and alfresco dining – featuring U-shaped seating and atmospheric pop-up lights.

TWO ROOFS FOR A SUNNY FEELING

Open the two electric roofs and let the sunshine accompany your summer holiday! No other 50-footer gives you that feel of driving a cabriolet.

UNLIMITED PANORAMIC VIEW

Stunning seascapes wherever you look! The panoramic windows are beyond compare in this class. The amount of light inside is unique.

TREND-SETTING DESIGN



DESIGNED FOR THE 7 SEAS. DEDICATED TO THE 6 SENSES.

Breathe in the refreshing air. Enjoy the warm wind in your hair. Let your soul bathe in light. This fabulous cruiser brings you closer to the elements of nature than you have ever been before. The elegantly sweeping roof spans the largest panoramic windows in the 50-foot class. Portholes featuring a polygonal shape enrich the ensemble of modern forms and clear lines, to guarantee a phenomenal view even when you are below deck.



To make sure you can celebrate living under the open sky in all its variations, Sealine places great importance on highly convertible designs. Fold down the backrest of the stern bench to create a lie-down area at the cockpit table. When the table is lowered, both surfaces combine also into a huge sunbathing area. By putting the backrest in its upright position, you transform the cockpit into an alluring dining place. If you prefer some shade, just close the electric sun roof. You easily open it again for sunbathing in the afternoon.



At first sight, the C530 stands out with her floor-to-ceiling glass design. Her impressive panoramic windows span 5.8 metres in length. Let your family and friends see every bit of the beauty beyond! Priceless panoramic views are guaranteed from wherever you sit or stand. Thanks to the undivided windscreen, even the look ahead provides a spectacular picture of the seascape.



All Sealine models are born of the same values: They feature wide interior spaces, an amazing quantity of natural light and outstanding design with German engineering inside. As for these trademarks, the C530 displays the true spirit of Sealine.



enjoy the
LIGHT

feel the
SPACE

combine functionality with
DESIGN





WELCOME TO YOUR PRIVATE SUMMER ISLAND!

Cool off in the ocean. Let the sun caress your skin. Have some freshly grilled delights outside. When on deck, you enjoy the freedom to choose between bathing platform, cockpit and the lounge at the bow. At each of these ingeniously designed areas, summer life is bustling in all its colours.

EXTERIOR DESIGN





The moment you open the electric sun roof, you will immediately be enveloped by the irresistible cabrio atmosphere in the cockpit. An inspiration to enjoy any moment as you like: Whether mixing refreshing drinks at the wet bar, turning the seating group and teak table into a sunbathing lounge or even by watching television from here. When the glass door is open, the cockpit and saloon fuse together to become a single generous space.



The bathing platform on the C530 invites you to take a refreshing splash in the sea. The built-in steps unfold as the platform is lowered, providing a safe and comfortable step down even when the platform is below the water's surface. Or use the bathing ladder of stainless steel for a direct dip in the water. Look forward to the generously sized platform, which also offers plenty of space for taking along a tender boat.



Imagine there is nothing but the ocean beside you, and above you only sky. The luxurious lounge at the bow offers a completely unobstructed place. It is wonderful for resting and relaxing. The table electrically lowers into the floor to give you a large sunbathing platform. Thanks to the storage compartments beneath the seats you have your beach towels and sunhats always right at hand.





LOVE AT FIRST LIGHT.

Experience the fascinating feeling of being one with nature on the water. The floor-to-ceiling panoramic windows give you an expansive view of the horizon. The sophisticated carpeting perfectly blends in with the surroundings, with wood elements and leather seating that elegantly reflect the natural light.



The U-shaped galley is located between the saloon and the cockpit to comfortably serve both areas. It features a large fridge and freezer, electric cooktop and a microwave with grill function. For more individual fittings, you will find plenty of additional space.





Revel in luxurious living at all times in your yacht's elegant saloon. Turn the seating group into two sofas facing each other and let your guests enjoy the grand 360° panoramic view from either side. When you want to create a convivial atmosphere, simply return the seating to its U-shaped layout. For any occasion, the right drinks await you perfectly tempered in the stand-alone wine cooler directly behind the helm.





An eye-catcher in the saloon is the helm console which adds a spectacular touch to the space with its gleaming, chrome fittings. As beautiful as this setting is, it is naturally surpassed by the unforgettable view through the one-piece windscreen. The joy of driving can also be shared by two thanks to the twin pilot seats. By opening the starboard sliding door, the sidewalk and bow can be instantly entered from the helm.



Outstanding design and a generous interior await you in your private master cabin. The 160 cm wide and 200 cm long king-size bed truly reflects the grandeur of this motor yacht and leaves nothing more to be desired. The two elongated hull windows at sea level not only shape the magnificent exterior of the yacht, they also lighten up the master cabins interior with ample of natural light. Both sides of the cabin feature a broad chaise longue. On the port side, a beautiful vanity table with a fold-out mirror is optional.



As you would expect from Sealine, comfort and liveability can be found throughout the entire lower deck. The VIP cabin at the bow impresses with an outstanding amount of light, thanks to large hull windows and a skylight above. The headroom surpasses everyone's expectations.

Just like the owner's suite, your en-suite head and shower represent a highlight of their own. The bathroom is full of high-grade fittings such as an electric toilet, slide up mirror and diffused lighting.

Pass through the translucent door to the shower, where a teak-laid shower seat and a handheld spray head adjustable in height awaits you. Above your head, a rainfall shower is installed, beautifully framed by a rectangular strip light.

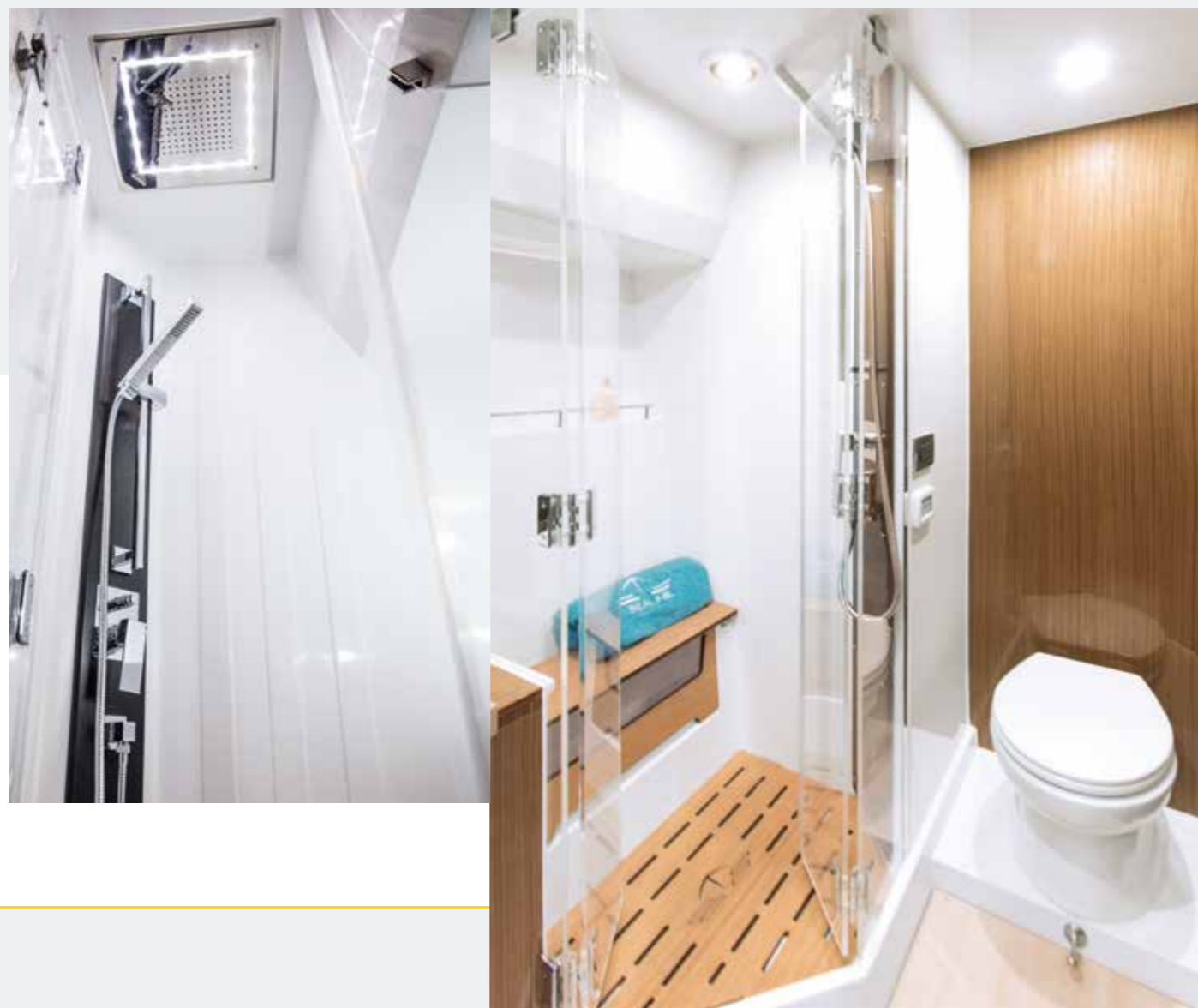



Having seen both owner's suite and VIP cabin, it is hard to believe this yacht features even more comfortable accommodation within a length of 53 feet. There is a third double cabin to the portside, also pleasing your guests with high headroom and generous bed sizes. True to Sealine's trademarks, this cabin is bathed in sunshine through its own hull window and skylight.

Even a seventh bed can be provided if the utility room at the stern is being used as crew cabin. Otherwise, this space can host all kinds of storage for a long-term cruise.





When you think of motor yachts, does a thrilling driving experience also come to mind? Then opt for the Sealine C530 – with its Volvo IPS engines. Even the standard engines with 870 hp accelerate the yacht up to 26 knots. If you ever wanted to experience just how agile 53 feet can be, we boost the performance of your Sealine to 1,200 hp with two Volvo IPS800 engines and a max. speed of 33 knots.



PRINCIPAL DIMENSIONS (according to ISO 8666)

LOA	16.13 m	52' 9"
Beam	4.56 m	14' 9"
Draught	1.36 m	4' 5"
Air Height	6.05 m	19' 8"
Fuel capacity	1,560 l	343 UK gal
Water capacity	766 l	168 UK gal
Displacement (approx.)	19.98 t	19.66 UK t
Max people on board	12	
CE Category	B	

ENGINE

2 x Volvo Penta IPS600, Pod Drive	26 knots*
2 x Volvo Penta IPS700, Pod Drive	30 knots*
2 x Volvo Penta IPS800, Pod Drive	33 knots*

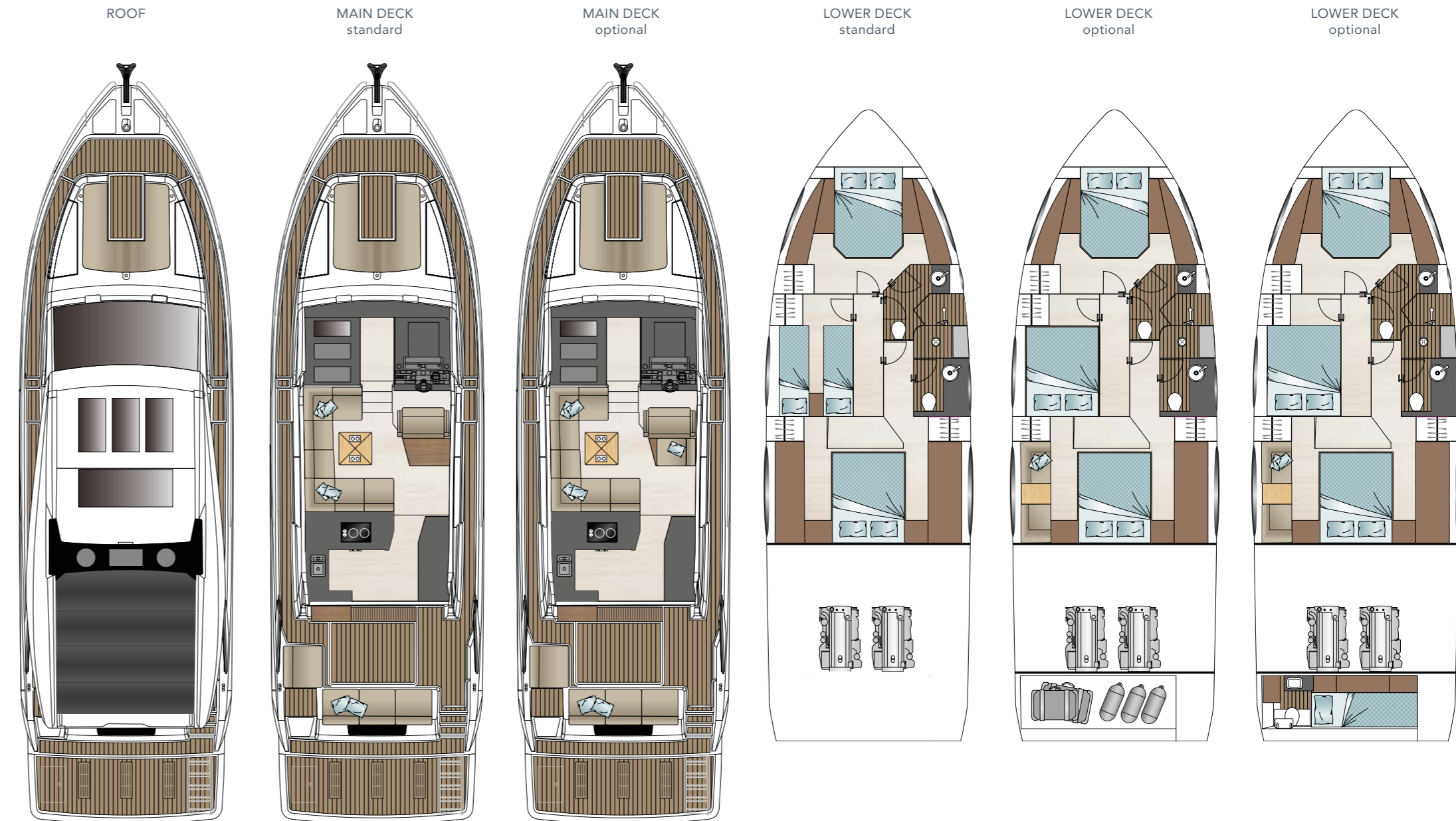

* All performance figures are given in good faith and are intended as an indication. These figures cannot be guaranteed as top speed in particular is affected by the cleanliness of the hull, conditions of the propellers, weight carried and air/sea temperature. Performance is related also to the optional accessories selected. SEALINE reserves the right to change specifications in line with the company policy of improvement through research and development. Errors and omissions expected. Please check with your dealer for a full list of inclusions.

This brochure is not contractual. The yachts depicted partly comprise special equipment not included in the standard scope of supply. Illustrations may not correspond with current versions. Subject to alterations in design and equipment without notice and errors excepted. Renderings: Solidwave Visualisation. Photos: Nico Krauss. Artwork: smz GmbH



GREAT DESIGNERS CREATED YOUR C530. BE ONE OF THEM.

There are countless ways to kit out the interior of your yacht. No matter what materials you choose: Quality will always be first class. Carefully selected fabrics, exquisite floorings and a wide range of well-balanced colours create an ambience you'll enjoy anew every day.

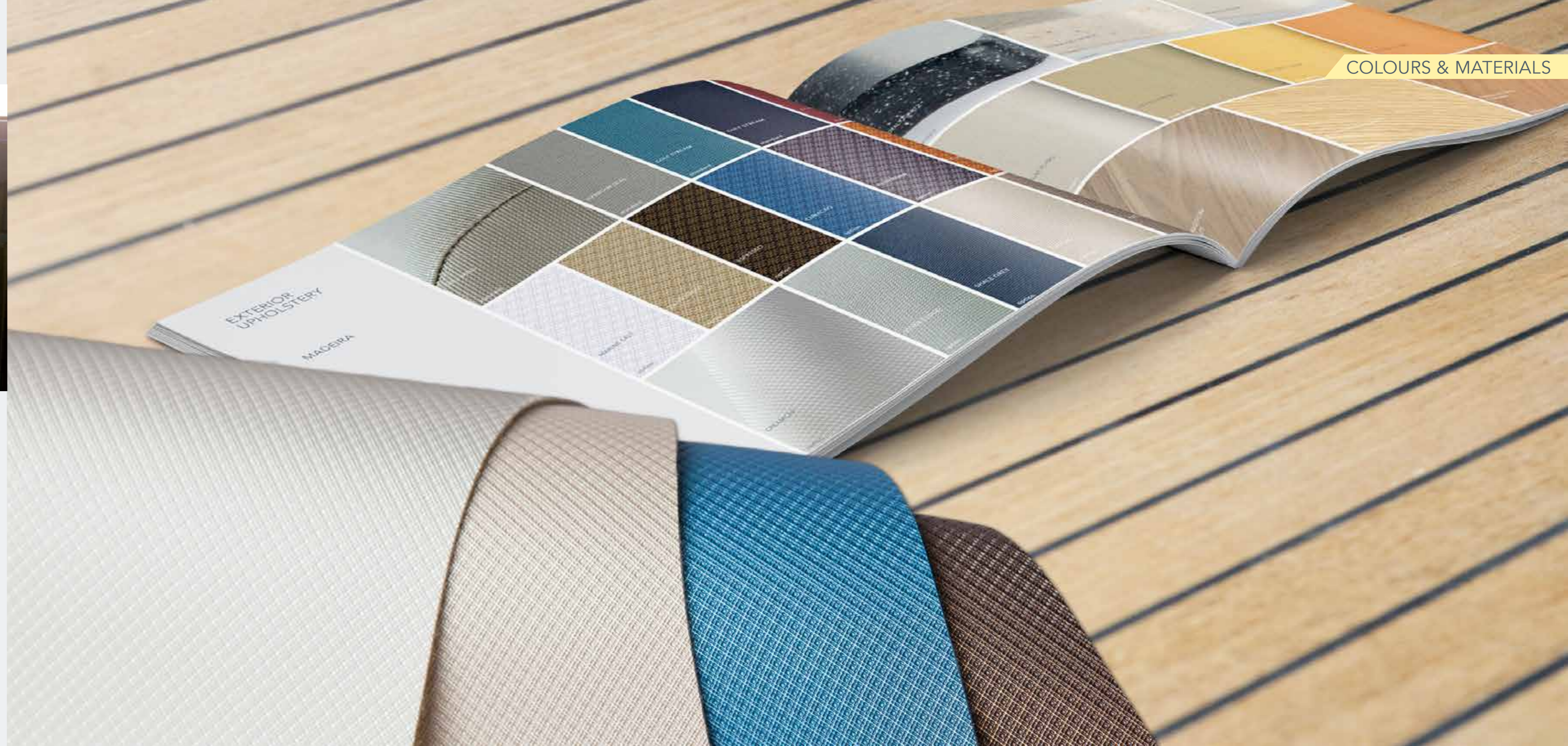

COLOURS & MATERIALS



Our fabrics are made of natural materials that show attractive textures and beautiful woven patterns. The leathers are classy, extremely resilient and gentle to touch.

If you have individual requirements about the finishes, you are always welcome to challenge our craftsmen with your special requests. Measuring up to your unique taste is one of Sealine's greatest qualities.

Don't hesitate to create a look that is as individual as you are. The hull and the waterline of your C530 can be painted in almost any colour according to the Alexseal Yacht Coating Selection.

All worktops are made of CORIAN®. This premium surface combines high performance with outstanding aesthetics. It is best known for its seamless appearance and stunning effects of colour and translucency. Furniture wood can be ordered in a satin or high-gloss finish on demand. The carpets of the cabins are woven of the finest wool.

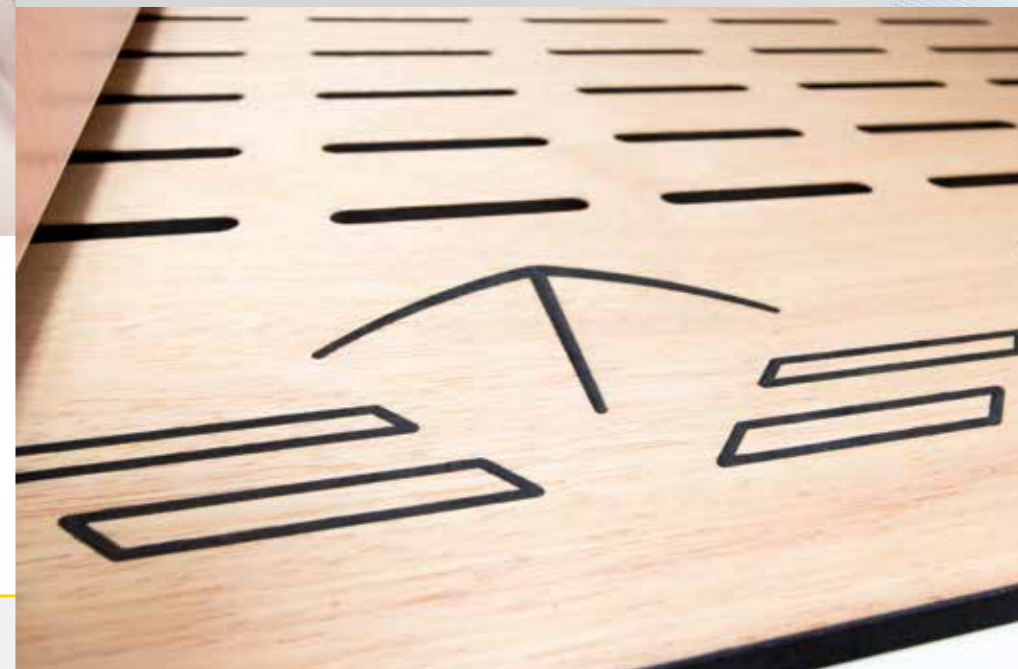

BRAND PHILOSOPHY



GERMAN PRECISION AND PASSION FOR THE SEA. THAT'S WHAT A SEALINE IS MADE OF.

In 2013, the Sealine brand found a worthy new home on the German Baltic coast. At our shipyard in Greifswald, we have perfected the interplay between state-of-the-art manufacturing techniques and skilled employees.

The outstanding people in our team perform their work with enormous experience, a deep understanding of the customer and great dedication.

In addition, we are thrilled to cooperate with our British partner Bill Dixon. Working closely with our in-house personnel, the award-winning designer is creating a new range of innovative Sealine models.

Above all, we believe that what holds true for the experienced boater, also holds true for us as boat builders. Beyond the individual skill, there is something which genuinely binds all of us at Sealine: A great passion for the sea.



DROP ANCHOR AT SEALINE

YOUR LOCAL SEALINE DEALER IS LOOKING
FORWARD TO YOUR VISIT.

PANORAMIC VIEW . EASY CRUISING
DAYLIGHT INSIDE . GENTLE BREEZE
HIDDEN COVES . SUNBATHE AT SEA
BUSTLING HARBOURS . FAMILY FUN
ALFRESCO DINING . STARS ABOVE

C330 C430 C530 F530 S330



www.sealine.com

Sealine Ladebower Chaussee 11 D-17493 Greifswald