



SPECIFICATION & PRICELIST S330

PRINCIPAL DIMENSIONS according to ISO 8666

Length Overall (Lmax)	10.31 m	33' 10"
Length of Hull (LH)	9.99 m	32' 9"
Beam (BH)	3.50 m	11' 6"
Draught (Tmax)	0.98 m	3' 3"
Air height	3.39 m	11' 1"
Fuel capacity	570 l	125 UK gal
Water capacity	220 l	48 UK gal
Displacement	6.14 t	6.04 UK t
CE Category	B	B
Max. persons	8	8

ENGINE STANDARD

1 x Volvo Penta D6-340 27/28 knots*

ENGINE OPTIONS

2 x Volvo Penta D3-220 31/32 knots*

1 x Volvo Penta D6-400 31/32 knots*



*All performance figures are given in good faith and are intended as an indication. These figures cannot be guaranteed as top speed in particular is affected by the cleanliness of the hull, conditions of the propellers, weight carried and air/sea temperature. Performance is related also to the optional accessories selected. SEALINE reserves the right to change specifications in line with the company policy of improvement through research and development. Standard Propeller tested in Greifswald according to Volvo conditions. All measurements/figures approximate. Errors and omissions excepted. Specification and material can be changed without notice. Please check with your dealer for a full list of inclusions. Valid from 2021.01.01.

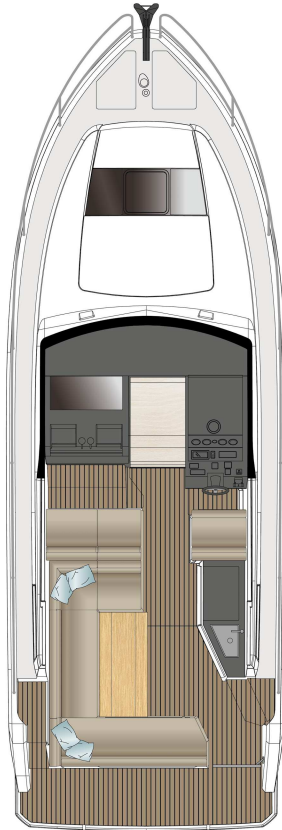

MAIN DECK

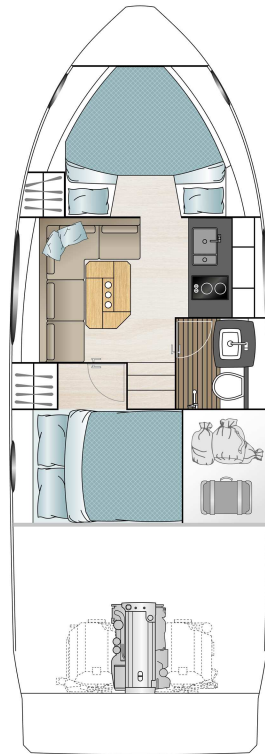

LOWER DECK
standard

A1

B1

C1

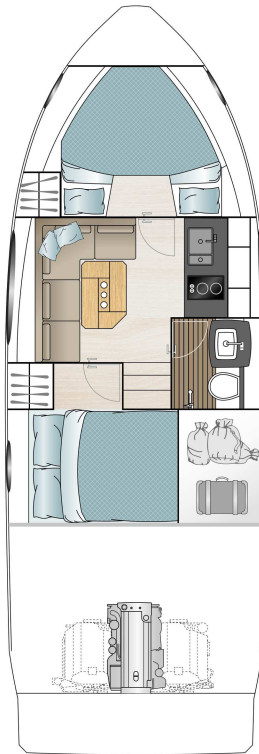

LOWER DECK
optional

A2

B1

C1

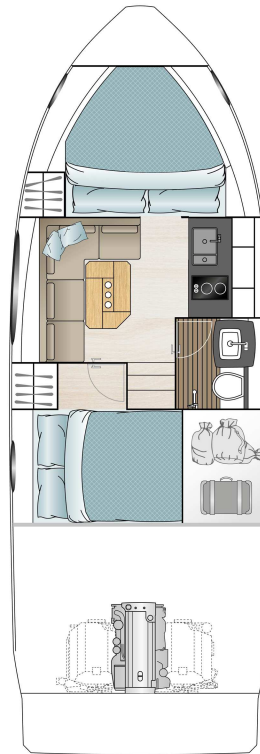

LOWER DECK
optional

A3

B1

C1

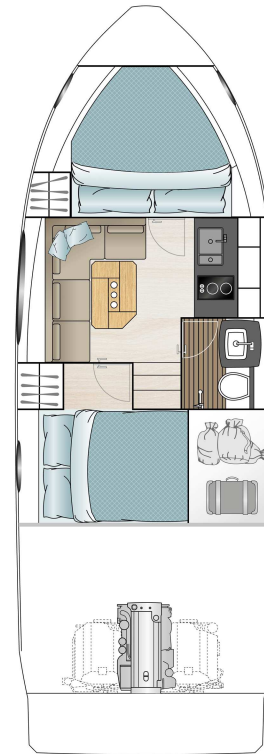

LOWER DECK
optional

A4

B1

C1

HULL

- GRP hull with sandwich construction, isophthalic gelcoat, colour: STAR WHITE, 1st layer vinyl ester resin
- Waterline, isophthalic gelcoat, colour: BLACK
- Aft pillar vinyl wrapped in GREY with SEALINE logo
- 4 hull windows not openable (master cabin, guest cabin port side, galley, saloon)
- 2 hull windows with openable porthole (guest cabin port side and toilette)

DECK & COCKPIT

- GRP deck with antislip surface, isophthalic gelcoat, colour: STAR WHITE, 1st layer vinyl ester resin, double anchor locker, self draining, anchor arm stainless steel
- Fender strip, rubber, colour: BLACK
- SEALINE steering wheel and throttles
- Full windscreen with pantograph wipers and screen wash
- Bathing platform in fiberglass, bathing ladder with handrail and bathing shower with hot and cold water and opening stainless steel gate.
- Stainless steel pulpit, 4 stainless steel mooring cleats, stainless steel handrails
- Seating "U"-shaped bench with fixed backrest and table with fixed leg. Manual bimini. External galley with sink, cold and hot water and storage. Pilot seat plus 2 copilot seats.
- Table in cockpit with fixed leg and cover, on port side, electric engine hatch

PROPULSION

- Engine room, sound insulated, fans with fire extinguisher system, automatic and manual, Batteries-Engines: 1 x 95 Ah, Battery charger 50 A (for engine and service batteries)
- 1 Volvo Penta D6 (340 hp) stern drive propeller: G3, Volvo engine instrumentation
- Volvo engine instrumentation 2.5" display
- Fuel tank, capacity: 570 litres

- Fuel Filter

ELECTRICAL EQUIPMENT

- 12 V and 230 V electric system with 230 V shore power connection. Sockets in saloon (1), master cabin (2), guest cabin (1), galley (2), toilette (1) and 12V on dashboard (1)
- Batteries-Service: 2 x 160 Ah
- Country Version: EU / AUS
- Manual toilet
- Light in cabins, saloon and galley with dimmer. Dimmable indirect lights and reading lights in cabins. Lights in toilettes, cockpit and engine room
- Holding tank (85 l)
- Water tank (220 l) with gauge, fresh water pump and boiler (22 l)
- Bilge pumps: automatic electric (2) and manual emergency bilge pump in cockpit (1)

NAVIGATION & INSTRUMENTS

- Standard dashboard with engine room fire extinguisher system
- Compass
- Navigation lights

LAYOUT & INTERIOR

- A1: Master cabin with "V" berth and wardrobe. 3 Skylights, one openable. Open access to saloon.
- B1: Saloon with "L"-shaped sofa and storage. Galley with stowage, fridge, 2 burner gas hob and sink with draining basin, fully equipped head with handheld shower.
- C1: Guest cabin with double berth, 1 wardrobe and storage
- Saloon table with fixed leg
- Counter tops in galley, in BISTRO material (according to colour card)

UPHOLSTERY & WOOD

- Upholstery scheme CASABLANCA, colour: PEARL WHITE (according to colour card)
- Exterior seating material and upholstery helmsman seat in SARDINIA, colour: GULL WING (according to colour card).
- Standard mattresses in all cabins
- Interior furniture in high quality marine plywood: MADISON WOOD (according to colour card). Bedheads in master cabin in MADISON WOOD (according to colour card) and guest cabin in soft material.
- Saloon, galley flooring and cabins in AUSTRALIAN ACACIA (according to colour card)
- Heads flooring - wood style

TRANSPORT

- Identified locations for hand held fire extinguishers - (hand held fire extinguishers are not supplied), SEALINE Owner's Manual in SEALINE document bag

AS PER STANDARD SPECIFICATION		excl. VAT 189.950 €
PROPULSION		
XC2001	Volvo Penta D6-340 (340 hp), Duoprop stern drive (single engine) with propeller G2	300 €
XC2005	2 Volvo Penta D3-220 (220 hp), Duoprop stern drive with electric steering with propeller IH4	22.900 €
XC2006	2 Volvo Penta D3-220 (220 hp), Duoprop stern drive with electric steering with propeller IH3	23.200 €
XC2010	Volvo Penta D6-400 (400 hp), Duoprop stern drive (single engine) with propeller G2	19.900 €
XC5001	Joystick for stern drives (only with XC2005 or XC2006)	13.650 €
XC5011	Volvo Penta multifunction 7" display	3.875 €
XC5101	Automatic control of roll and pitch in the trim tab (only with XW3000 or XW3010)	1.250 €
XC7001	Steering wheel, adjustable tilt	670 €

PACKAGES

XW2000	Navigation Package	9.990 €
XN1001	Raymarine i70s multifunctional display with transducer (speed, depth, temp) at helm position	
XN1501	Raymarine AXIOM PRO 9 chart plotter at helm position with GPS antenna	
XN1602	Enlarged dashboard	
XN2101	Raymarine Ray90 VHF	
XN3001	Raymarine Autopilot with control unit at helm position	
XN6001	VHF antenna with splitter for FM and AIS	

XW3000	Cruising Package	11.240 €
XB4005	Anchor 10 kg, galvanized with 30 m of chain	
XB4010	Windlass electric with automatic fuse	
XB4122	2 additional cleats at mid ship, 1 at each side	
XC5100	Trim Tabs	
XC6001	Bowthruster, 4 hp	
XC7001	Steering wheel, adjustable tilt	
XN3550	MySealine safety cloud with 24 months subscription and device installed on board	
XV1000	Cockpit canopies (according to colour card)	
XV1005	Cover for dashboard (according to colour card)	
XV5001	4 fenders	
XV9902	4 mooring lines	
XW3010	Upgrade to Cruising Package XW3000 - instead of galvanized anchor	3.990 €
XB4006	Anchor 10 kg, stainless steel with 50 m of stainless steel chain	
XD1002	Battery set, capacity: 3x 160 Ah	
XD2001	Inverter/charger (only with XD1002)	
XW5000	Comfort Package	10.990 €
XB1032	Teak on cockpit floor, bathing platform and steps to the sidewalk	
XB4310	Freshwater wash down	
XB5501	Table in cockpit with teak and high/low leg, convertible into sunpad with cover	
XD3202	Toilet, electrical	
XD4020	6 LED lights in cockpit (ceiling)	

XD5011	Cockpit refrigerator	
XU1020	Sunbed cushions for foredeck (according to colour card)	
XV7500	Mosquito nets in fwd hatch	
XV9060	Blinds for hull windows	
XV9061	Blinds for hatches	
XW5001	Upgrade to Comfort Package XW5000 - instead of teak	890 €
XB1033	Synthetic teak on cockpit floor, bathing platform and steps to the sidewalk (according to colour card)	
XW6000	Dock & Drive Power Package (only with XC2005 or XC2006)	17.900 €
XC5001	Joystick for stern drives (only with XC2005 or XC2006)	
XC5002	Volvo cruise control	
XC5003	Volvo power trim assistant	
XN5001	Volvo trip computer	
XW7000	Entertainment Package - saloon and cockpit (only with XN6001 or XW2000)	2.230 €
XE2000	FUSION MS-AV755 DVD/CD Player with AM/FM in saloon	
XE2101	2 high-end 2 way speakers in saloon	
XE2107	2 high-end 2 way speakers in cockpit	
XE2207	FUSION MS-NRX remote control at helm position	
XE3110	FUSION wireless link - remote control via mobile devices	
XW7501	TV Package - saloon	1.490 €
XE5001	TV flat screen in saloon	
XE5010	TV preparation in saloon	

XE5111 DVB-T2 digital tv antenna

OPTIONS

excl. VAT

HULL

XA1001	GRP hull, painted, non metallic (according to colour card)	10.500 €
XA1002	GRP hull, painted, metallic (according to colour card)	14.300 €
XA2001	Waterline, painted, non metallic (according to colour card)	900 €
XA2002	Waterline, painted, metallic (according to colour card)	1.100 €
XA5105	Openable glass porthole in master cabin on port side	880 €
XA5116	Galley hull window with openable porthole	980 €

DECK & COCKPIT

XB1021	Teak on side decks	3.900 €
XB1022	Synthetic teak on side decks (according to colour card)	4.400 €
XB1505	Hull fender strip in white rubber with stainless steel insert	1.900 €
XB3301	Closed side windows in cockpit with sliding openable frame	2.250 €
XB3501	Bathing platform extension with teak (only with XW5000)	4.750 €
XB3506	Bathing platform extension with synthetic teak (according to colour card - only with XW5000 and XW5001)	5.350 €
XB3550	Wire railing	490 €
XB4110	Anchor chain counter (only with XW3000 or XW3010)	490 €
XB4122	2 additional cleats at mid ship, 1 at each side	590 €
XB4300	Freshwater dockside connection in transom	450 €
XB4310	Freshwater wash down	850 €
XB5201	Convertible aft backrests lower and raise	1.190 €

ELECTRICAL EQUIPMENT

XD1002	Battery set, capacity: 3x 160 Ah	650 €
XD1601	Country Version: US / JPN	3.490 €
XD1602	Country Version: UK	690 €
XD2001	Inverter/charger (only with XD1002)	2.800 €
XD3001	Fisher Panda generator 5000i, 4.0 kW	12.900 €
XD3101	2nd shore power 230 V or 110 V	1.590 €
XD5002	Ceramic stove (only with XD5150) (only with XD3001 or XD3101 or XD6001 or XD6002)	1.250 €
XD5030	Cockpit BBQ with gas	990 €
XD5150	Microwave	790 €
XD5200	Gas Leak Detector	740 €
XD6001	Air conditioning Class E (European) incl. 2nd shore power (only with XD3001)	8.900 €
XD6002	Air conditioning Class G (Gulf) incl. 2nd shore power (only with XD3001)	9.900 €
XD7001	Heating, Eberspächer D4 Plus - outlets in aft cabin in saloon and head (not with XD6001 or XD6002)	3.750 €
XD7021	Additional heating outlet in cockpit (only with XD7001)	450 €
XD8003	Grey-water tank with electric pump for overboard discharge or deck suction	2.900 €

NAVIGATION & INSTRUMENTS

XN1005	Additional Raymarine i70s multifunctional display at helm position (only with XW2000)	700 €
XN1602	Enlarged dashboard	3.000 €

XN2001	Raymarine Quantum Radar 2 (only with XN2004 and XW2000)	3.615 €
XN2004	Enlarged mast	390 €
XN3500	AIS (only with XW2000)	1.490 €
XN3600	Raymarine fishfinder (only with XW2000)	1.550 €
XN3815	Raymarine ClearCruise Augmented Reality (AR) incl. Gyroscope, GPS antenna and Raymarine IP67 camera installed in the roof (only with XW2000)	2.380 €
XN6001	VHF antenna with splitter for FM and AIS	625 €
XN9200	Spotlight with remote control (only with XN2004)	790 €

LAYOUT & INTERIOR

XL1002	A2: Master cabin with "V" berth and wardrobe. 3 Skylights, one openable. Separated from saloon by door.	1.750 €
XL1003	A3: Master cabin with "V" berth convertible into double berth and wardrobe. 3 Skylights, one openable. Open access to saloon.	450 €
XL1004	A4: Master cabin with "V" berth convertible into double berth and wardrobe. 3 Skylights, one openable. Separated from saloon by door.	2.200 €
XL8001	Countertop in lower bridge galley - ROMAN STONE (frames in marine mineral stone, top in HPL - according to colour card)	450 €

UPHOLSTERY & WOOD

XU1001	Upholstery - BALI (according to colour card)	750 €
XU1002	Upholstery - CAPETOWN (according to colour card)	910 €
XU1003	Upholstery - LIMA (according to colour card)	1.300 €
XU1004	Upholstery - LONG ISLAND LEATHER (according to colour card)	2.400 €
XU1005	Upholstery upgrade in saloon, with pillows (according to colour card)	1.100 €

XU1011	Exterior upholstery - SARDINIA (according to colour card)	590 €
XU1012	Exterior upholstery - MADEIRA (according to colour card)	590 €
XU1013	Exterior upholstery - MALIBU (according to colour card)	735 €
XU1020	Sunbed cushions for foredeck (according to colour card)	1.990 €
XU1110	Comfort mattresses for all berths	990 €
XU1500	Carpet in cabins (according to colour card)	1.450 €
XU1520	Carpet in saloon (according to colour card)	1.200 €
XU5001	Furniture - ONTARIO OAK (according to colour card)	3.900 €
XU5002	Furniture - SHERWOOD CHESTNUT (according to colour card)	4.400 €
XU5003	Furniture - ATLANTA WALNUT (according to colour card)	3.600 €
XU5100	Furniture - HIGH GLOSS FINISH (only for XU5002 or XU5003)	7.300 €
XU6011	Floorboard in saloon, galley and cabins - VELVET OAK (according to colour card)	980 €
XU6012	Floorboard in saloon, galley and cabins - VENECIAN BLACK WALNUT (according to colour card)	780 €
XU6013	Floorboard in saloon, galley and cabins - CALIFORNIAN OAK (according to colour card)	980 €

ACCESSORIES

XV1005	Cover for dashboard (according to colour card)	690 €
XV1007	Outside screen cover, front and side triangle screen (according to colour card)	1.780 €
XV1008	Cover for bow cushions (according to colour card)	990 €
XV2300	Wind protection for side and aft superstructure (according to colour card)	2.200 €
XV9380	Shrink wrap foil (for storage purpose only / not for transport) (not with XA1001, XA1002, XA2001, XA2002)	950 €

TRANSPORT

XZ2001	Loading on truck with disassembled deck parts and antennas	550 €
XZ2010	Cradle for sea transport	2.900 €
XZ2020	Ready for pickup	500 €

All mentioned prices in €, basic prices ex yard and excl. VAT. All weights and measures are calculated numbers based on the construction data. Changes in construction and equipment reserved. Above mentioned prices are recommended for ex yard deliveries within 4 month after order confirmation. For later delivery time the company reserves right to apply latest price list. Company reserves additional 15 working days when painted hull or deck is ordered. All measurements/figures are approximate. Errors and omissions excepted. Specification and material can be changed without notice. Valid from 2021.01.01.