



## SPECIFICATION & PRICELIST C530

### PRINCIPAL DIMENSIONS according to ISO 8666

Length Overall (Lmax)	16.13 m	52' 11"
Length of Hull (LH)	14.64 m	48' 0"
Beam (BH)	4.56 m	14' 11"
Draught (Tmax)	1.30 m	4' 3"
Air Height	6.05 m	19' 10"
Fuel capacity	1560 l	343 UK gal
Water capacity	766 l	168 UK gal
Displacement	20.32 t	20.00 UK t
CE Category	B	B
Max. persons	12	12

### ENGINE STANDARD

2 x Volvo Penta IPS700 - Pod drive 30 knots\*

### ENGINE OPTION

2 x Volvo Penta IPS800 - Pod drive 33 knots\*



\*All performance figures are given in good faith and are intended as an indication. These figures cannot be guaranteed as top speed in particular is affected by the cleanliness of the hull, conditions of the propellers, weight carried and air/sea temperature. Performance is related also to the optional accessories selected. SEALINE reserves the right to change specifications in line with the company policy of improvement through research and development. Standard Propeller tested in Greifswald according to Volvo conditions. All measurements/figures approximate. Errors and omissions excepted. Specification and material can be changed without notice. Please check with your dealer for a full list of inclusions. \*\*To be confirmed after seatrial. Valid from 2023.01.01 for deliveries until 2023.12.31.

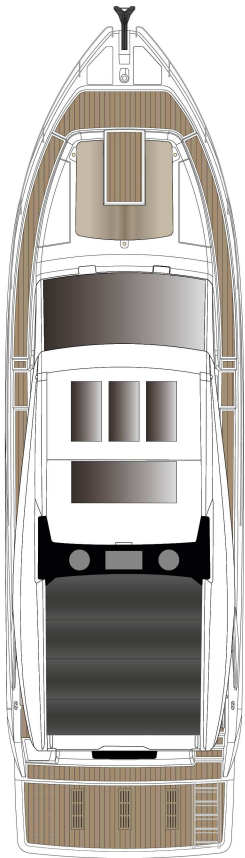

ROOF



MAIN DECK  
standard

E1

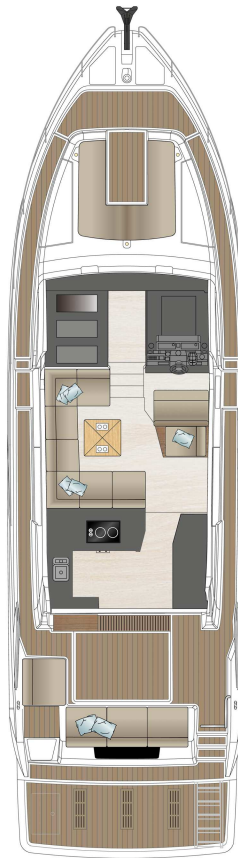

MAIN DECK  
optional

E2

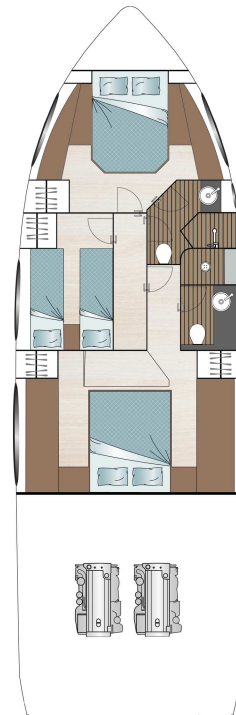

LOWER DECK  
standard

A1

B1

C1

D1

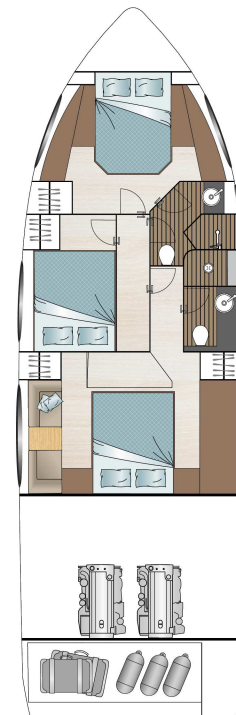

LOWER DECK  
optional

A1

B2

C2

D2

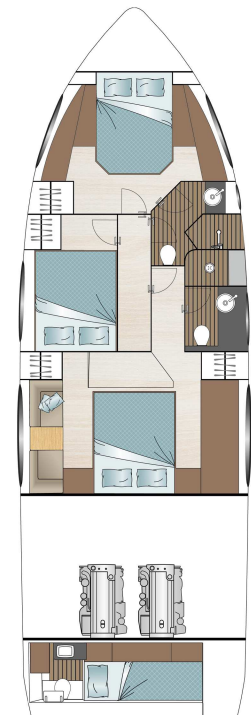

LOWER DECK  
optional

A1

B2

C2

D3

## HULL

- GRP hull with sandwich construction, isophthalic gelcoat, colour: STAR WHITE, 1st layer vinyl ester resin
- Waterline, isophthalic gelcoat, colour: BLACK
- Aft pillar vinyl wrapped in GREY with SEALINE logo
- 2 hull windows (master cabin on port side, VIP cabin on port side)
- 5 hull windows with openable porthole (master cabin on starboard side, VIP cabin on starboard side, guest cabin and toilettes)

## DECK & COCKPIT

- GRP deck with antislip surface, isophthalic gelcoat, colour: STAR WHITE, 1st layer vinyl ester resin, anchor locker, self draining, anchor arm stainless steel
- Fender strip, rubber, colour: WHITE, with stainless steel inlay
- SEALINE steering wheel with tilting system, joystick and throttles
- Full windscreen with pantograph wipers and screen wash
- Panoramic full, clear glass windows with door to starboard side and two fixed skylights in saloon
- SEALINE convertible fabric roof system in cockpit, electric
- Sliding door between cockpit and galley and tilting window to enlarge galley into cockpit
- Bathing platform and steps to cockpit with teak, bathing ladder with handrail and bathing shower with hot and cold water and opening stainless steel gate
- Stainless steel pulpit, 6 stainless steel mooring cleats, stainless steel handrails
- Seating bench with fixed backrest at stern on port side with storage and foldable teak bar, electric bimini
- U-shaped bench at bow with storage box
- Manual engine hatch

## PROPULSION

- Engine room, sound insulated, fans with fire extinguisher system, automatic and manual, Batteries-Engines: 2 x 90 Ah / 12 V, Battery charger 30 A (only for engine batteries)
- 2 Volvo Penta IPS700 (550 hp) - Pod drive including joystick control with propeller N3
- Volvo Penta engine instrumentation 7" display
- Manual Interceptor System
- Fuel tank, capacity: 1560 litres
- Fuel Filter

## ELECTRICAL EQUIPMENT

- 12 V and 230 V electric system with 230 V shore power connection.
- Sockets in saloon (1), master cabin (3), VIP cabin (2), galley (2), guest cabin (1), toilettes (1), engine room (1) and 12 V on dashboard (1)
- Batteries-Service: 3x 260 Ah / 12 V, inverter/charger 12 V / 3000 W - 150 A
- Country Version: EU / AUS
- Electric toilets
- Light in cabins, saloon and galley with dimmer
- Dimmable indirect lights and reading lights in cabins
- Lights in toilettes, cockpit and engine room
- Front screen demister
- Holding tank (340 l)
- Water tank (766 l) with gauge, fresh water pump and boiler (40 l)
- Bilge pumps: automatic electric (2) and manual emergency bilge pump in cockpit (1)

## NAVIGATION & INSTRUMENTS

- Standard dashboard with engine room fire extinguisher system
- Compass
- Navigation lights

## LAYOUT & INTERIOR

- A1: VIP cabin with double berth, wardrobe and sideboards with stowage, mirror and two bedside tables. 3 skylights, one openable, direct access to separated day head
- B1: Guest cabin with twin berths, one drawer underneath, wardrobe and stowage on port side and bed table. Fully equipped day and guest head, separate shower stall with handheld shower and bracket. Comfort seat with wood cover.
- C1: Master cabin with double berth and drawers underneath, wardrobes and sideboards with stowage, mirrors and two bedside tables. Fully equipped master cabin head, separate shower stall with raining and hand shower, comfort seat with wood cover.
- D1: Engine room with possibility to upgrade to the option D2 (storage room) or D3 (crew cabin)
- E1: Saloon with two sofas, convertible into U-shaped sofa. Pilot and copilot seats with sideboard behind. Galley with stowage, fridge with freezer compartment, ceramic electric stove - 2 burners, microwave with grill and sink with draining basin.
- Saloon table with fixed leg
- Worktop in galley - MARINE MINERAL STONE, colour: PEBBLE GREY (according to colour card)

## UPHOLSTERY & WOOD

- Upholstery scheme CASABLANCA, colour: PEARL WHITE (according to colour card)
- Exterior seating material in SARDINIA GULL WING (according to colour card)
- Upholstery helmsman seats: LONG ISLAND LEATHER, colour: PALISANDER (according to colour card). Cabin bedheads in Spradling Horizon, colour: IVOIRE and bedframes in Diamante, colour METEOR.

- Standard mattresses in all cabins
- Carpet in cabins (according to colour card)
- Interior furniture in high quality marine plywood: MADISON WOOD (according to colour card)
- Saloon and galley flooring in AUSTRALIAN ACACIA (according to colour card)

## TRANSPORT

- Identified locations for hand held fire extinguishers - (hand held fire extinguishers are not supplied), SEALINE Owner's Manual in SEALINE document bag

AS PER STANDARD SPECIFICATION		excl. VAT 1.064.500 €
<b>PROPULSION</b>		
XC2006	2 Volvo Penta IPS700 (550 hp) - Pod drive including joystick control with propeller N2	400 €
XC2010	2 Volvo Penta IPS800 (600 hp) - Pod drive including joystick control with propeller N4	34.550 €
XC2011	2 Volvo Penta IPS800 (600 hp) - Pod drive including joystick control with propeller N3	34.850 €
XC4001	Docking Station, 2nd joystick control in cockpit (incl. bowthruster control, when XW3000 selected)	6.700 €
XC5005	Volvo Penta Dynamic Positioning System	25.300 €
XC5101	Auto trim, List and Coordinated Turn for Volvo Interceptor System	7.450 €
XC5201	Double fuel filter with bypass	4.000 €

**PACKAGES**

<b>XW2020</b>	<b>Navigation Package Basic</b>	<b>10.350 €</b>
XN1001	Raymarine i70s multifunctional display with transducer (speed, depth, temp) at helm position	
XN1501	Raymarine AXIOM PRO 12 chart plotter at helm position with GPS antenna	
XN1602	Enlarged dashboard	
<b>XW2021</b>	<b>Upgrade to Navigation Package Basic XW2020 - instead of AXIOM PRO 12</b>	<b>3.000 €</b>
XN1502	Raymarine AXIOM XL 16 chart plotter at helm position with GPS antenna	

<b>XW2000</b>	<b>Navigation Package</b>	<b>17.750 €</b>
XN1001	Raymarine i70s multifunctional display with transducer (speed, depth, temp) at helm position	
XN1501	Raymarine AXIOM PRO 12 chart plotter at helm position with GPS antenna	
XN1602	Enlarged dashboard	
XN2101	Raymarine Ray90 VHF	
XN3001	Autopilot with control unit at helm position	
XN6001	VHF antenna with splitter for FM and AIS	

<b>XW2010</b>	<b>Upgrade to Navigation Package XW2000 - instead of AXIOM PRO 12</b>	<b>3.000 €</b>
XN1502	Raymarine AXIOM XL 16 chart plotter at helm position with GPS antenna	

<b>XW3110</b>	<b>Cruising Package Basic</b>	<b>13.750 €</b>
XB4005	Anchor 32 kg, stainless steel with 60 m chain	
XB4010	Reversible electric windlass with automatic fuse and remote control at helm position	
XB4120	4 additional cleats, 2 at each side	
XV5001	8 fenders	
XV9902	4 mooring lines	

<b>XW3100</b>	<b>Cruising Package</b>	<b>25.600 €</b>
XB4005	Anchor 32 kg, stainless steel with 60 m chain	
XB4010	Reversible electric windlass with automatic fuse and remote control at helm position	

XB4120	4 additional cleats, 2 at each side
XC6001	Bowthruster, 9 hp
XV1000	Cockpit canopies (according to colour card)
XV1007	Outside screen cover (according to colour card)
XV5001	8 fenders
XV9902	4 mooring lines

<b>XW5010</b>	<b>Comfort Package Basic</b>	<b>19.800 €</b>
---------------	------------------------------	-----------------

XB1034	Teak on cockpit floor, sidewalks (first step included) and two steps to cockpit
XL7010	Bow table with cover and possibility to convert into sunpad (only with XU1020)
XU1020	Bow dinette cushions (according to colour card)
XV7500	Mosquito nets in fwd hatch

<b>XW5011</b>	<b>Upgrade to Comfort Package Basic XW5010 - instead of teak</b>	<b>3.500 €</b>
---------------	--	----------------

XB1035	Synthetic teak on cockpit floor, sidewalks (first step included) and two steps to cockpit (according to colour card)
--------	--

<b>XW5000</b>	<b>Comfort Package</b>	<b>27.900 €</b>
---------------	------------------------	-----------------

XA5102	Openable glass porthole in VIP cabin on port side
XA5105	Openable glass porthole in master cabin on port side
XB1034	Teak on cockpit floor, sidewalks (first step included) and two steps to cockpit
XB3111	Saloon opening roof, electric drive with blinds
XL7010	Bow table with cover and possibility to convert into sunpad (only with XU1020)

XU1020	Bow dinette cushions (according to colour card)
--------	---

XV7500	Mosquito nets in fwd hatch
--------	----------------------------

<b>XW5001</b>	<b>Upgrade to Comfort Package XW5000 - instead of teak</b>	<b>3.500 €</b>
---------------	--	----------------

XB1035	Synthetic teak on cockpit floor, sidewalks (first step included) and two steps to cockpit (according to colour card)
--------	--

<b>XW5500</b>	<b>Exterior Lighting Package</b>	<b>2.800 €</b>
---------------	----------------------------------	----------------

XD4001	LED light package on side decks
XD4031	3 pop-up-lights at bow
XD4041	3 spot lights above each side walk

<b>XW7000</b>	<b>Entertainment Package - saloon and cockpit (only with XN6001 or XW2000)</b>	<b>3.450 €</b>
---------------	--	----------------

XE2000	FUSION APOLLO MS-RA770 with AM/FM in saloon
XE2101	4 high-end 2 way speakers in saloon
XE2107	2 high-end 2 way speakers in cockpit
XE2111	FUSION MS-AB206 - Dual Marine Active Subwoofer in saloon
XE2207	FUSION MS-ERX400 remote control in cockpit
XE3110	FUSION wireless link - remote control via mobile devices

<b>XW7002</b>	<b>Entertainment Package - VIP cabin (only with XE5110 or XE5111 and XN6001 or XW2000)</b>	<b>3.450 €</b>
---------------	--	----------------

XE2002	FUSION APOLLO MS-RA770 with AM/FM in VIP cabin
XE2103	2 high-end 2 way speakers in VIP cabin
XE5002	TV flat screen in VIP cabin
XE5012	TV preparation in VIP cabin



<b>XW7003</b>	<b>Entertainment Package - guest cabin (only with XE5110 or XE5111 and XN6001 or XW2000)</b>	<b>3.450 €</b>
---------------	--	----------------

XE2003	FUSION APOLLO MS-RA770 with AM/FM in guest cabin	
XE2104	2 high-end 2 way speakers in guest cabin	
XE5003	TV flat screen in guest cabin	
XE5013	TV preparation in guest cabin	

<b>XW7015</b>	<b>Entertainment Package - master cabin (only with XE5110 or XE5111 and XN6001 or XW2000)</b>	<b>4.600 €</b>
---------------	---	----------------

XE2005	FUSION APOLLO MS-RA770 with AM/FM in master cabin	
XE2106	4 high-end 2 way speakers in master cabin	
XE2116	FUSION MS-AB206 - Dual Marine Active Subwoofer in master cabin	
XE5005	TV flat screen in master cabin	
XE5015	TV preparation in master cabin	

<b>XW7018</b>	<b>Entertainment Package - bow (only with XW7000)</b>	<b>1.100 €</b>
---------------	---	----------------

XE2108	2 high-end 2 way speakers in on bow	
XE2208	FUSION MS-ERX400 remote control on bow	

<b>XW7501</b>	<b>TV Package - saloon (only with XE5110 or XE5111)</b>	<b>5.400 €</b>
---------------	---	----------------

XE5001	TV in saloon with high/low system, rotating 180 degrees	
XE5010	TV preparation in saloon	
XE5050	TV lifting system	

<b>OPTIONS</b>		<b>excl. VAT</b>
----------------	--	------------------

<b>HULL</b>		
-------------	--	--

XA1001	GRP hull, painted, non metallic (according to colour card)	33.400 €
XA1002	GRP hull, painted, metallic (according to colour card)	44.000 €

XA2001	Waterline, painted, non metallic (according to colour card)	1.850 €
XA2002	Waterline, painted, metallic (according to colour card)	2.200 €

<b>DECK &amp; COCKPIT</b>		
---------------------------	--	--

XB1021	Teak on side decks and bow	13.400 €
XB1022	Synthetic teak on side decks and bow (according to colour card)	13.700 €
XB3001	Passerelle, retractable	30.600 €
XB3211	Saloon door, port side	4.500 €
XB3212	Saloon door, starboard side	4.500 €
XB3501	Bathing platform with synthetic teak (according to colour card)	1.050 €
XB3502	High/Low movable bathing platform (hydro electric with safety lock system, 600 kg lift capacity)	28.690 €
XB4005	Anchor 32 kg, stainless steel with 60 m chain	2.200 €
XB4050	Mooring winch at stern on starboard side	2.500 €
XB4110	Anchor chain counter at helm position	990 €
XB4300	Freshwater dockside connection in transom	550 €
XB4310	Freshwater wash down	1.000 €
XB5101	Convertible aft backrest lower and raise (electric) in cockpit	3.400 €
XB5202	Pilot and Copilot seat electrical movable, high/low and fwd/bwd	7.700 €
XB5500	Table in cockpit with fixed leg, cover and electric engine hatch	5.100 €
XB5501	Table in cockpit with high/low leg, cover, sun cushion and electric engine hatch	8.200 €
XB5611	2 cockpit chairs, foldable	1.650 €
XB7500	Dinghy Chocks loose on board	900 €

## ELECTRICAL EQUIPMENT

XD1002	Battery set, capacity: 5x 260 Ah	4.300 €
XD1110	Deep charge protection for service protection	1.390 €
XD1601	Country Version: US / JPN	4.050 €
XD1602	Country Version: UK	1.450 €
XD3001	Fisher Panda generator 15000i, 12.0 kW	25.300 €
XD3101	2nd shore power 230 V or 110 V	1.850 €
XD3201	Toilet with bidet faucet in master cabin head	700 €
XD3301	Anti Rolling Gyro	86.500 €
XD4012	6 underwater multicolour lights (blue, green, red and white) at stern	6.950 €
XD4013	4 underwater multicolour lights (blue, green, red and white) underneath owner hull windows	4.600 €
XD5002	Electric cooktop, 4-rings	1.200 €
XD5014	Additional refrigerator in galley on starboard	2.100 €
XD5017	Refrigerator in master cabin (not with XD5311)	1.850 €
XD5020	Wine fridge in saloon	1.750 €
XD5021	Icemaker in galley (not with XD5210)	2.300 €
XD5040	Electric grill, furniture with sink, light and worktop, at stern	5.950 €
XD5160	Electric oven with microwave function	2.200 €
XD5210	Dishwasher (not with XD5021)	2.300 €
XD5311	Washer/dryer in the locker under companionway	2.300 €
XD5500	Watermaker 200 l/h (not with XD6002)	25.300 €
XD6001	Central air conditioning with chill system Class E (European) incl. 2nd shore power (only with XD3001)	47.390 €
XD6002	Central air conditioning with chill system Class G (Gulf) incl. 2nd shore power (only with XD3001)	66.050 €

XD6011	Air conditioning in crew cabin (only with XD6001 or XD6002)	4.290 €
XD7051	Hot water ring heating system	13.300 €
XD7060	Hot water ring heating system in crew cabin (only with XD7051)	2.100 €
XD8003	Grey-water tank with electric pump for overboard discharge or deck suction	5.650 €

## ENTERTAINMENT

XE5110	Raymarine 45 STV satellite antenna	9.100 €
XE5111	DVB-T2 digital tv antenna	1.050 €

## NAVIGATION &amp; INSTRUMENTS

XN1005	Additional Raymarine i70s multifunctional display at helm position (only with XW2000 or XW2010 or XW2020 or XW2021)	800 €
XN1506	Additional Raymarine AXIOM PRO 12 chart plotter at helm position (only with XW2000 or XW2020)	5.200 €
XN1507	Additional AXIOM XL 16 chart plotter at helm position (only with XW2010 or XW2021)	7.300 €
XN1602	Enlarged dashboard	4.050 €
XN2001	Raymarine Quantum Radar 2 (only with XN2004 and XW2000 or XW2010 or XW2020 or XW2021)	4.200 €
XN2004	Enlarged mast	1.750 €
XN2011	Empty Radar dome for symmetry	1.750 €
XN3500	AIS (only with XW2000 or XW2010 or XW2020 or XW2021)	1.750 €
XN3560	MySEALINE Safety Cloud hardware with 30 days free trial subscription and an interior light, switchable by APP	1.490 €
XN3600	Raymarine fishfinder (only with XW2000 or XW2010 or XW2020 or XW2021)	1.800 €

XN3800	Camera aft facing (only with XW2000 or XW2010 or XW2020 or XW2021)	2.190 €
XN3805	Thermal camera aft facing (only with XW2000 or XW2010 or XW2020 or XW2021)	19.000 €
XN3810	Thermal/imaging camera in engine room (only with XW2000 or XW2010 or XW2020 or XW2021)	2.450 €
XN3815	Raymarine ClearCruise Augmented Reality (AR) incl. Gyroscope, GPS antenna and Raymarine IP67 camera installed in the roof (only with XW2000 or XW2010 or XW2020 or XW2021)	2.750 €
XN4101	Satellite telephone - KVH Tracphone V3IP, Mini Vsat-System	34.550 €
XN6001	VHF antenna with splitter for FM and AIS	750 €
XN9200	Spotlight with remote control (only with XN2004)	900 €

### LAYOUT & INTERIOR

XL2002	B2: Guest cabin with double berth, 2 drawers underneath, wardrobe and stowage on port side. Fully equipped day and guest head with separate shower stall (with handheld shower and bracket comfort seat with wooden cover).	1.850 €
XL3002	C2: Master cabin with double berth, wardrobes, 2 bedside tables, vanity area (composed of a table with mirror, between two seats) on port side and sideboard with stowage on starboard side. Master cabin with full equipped head.	4.050 €
XL4002	D2: Engine room with storage space, door and window	5.200 €
XL4003	D3: Engine room with crew cabin, single berth, stowage, sink, toilet, door and window.	8.100 €
XL5002	E2: Saloon with two sofas, convertible into U-shaped sofa. Pilot and copilot bench convertible into chaise longue. Galley with stowage, fridge, freezer, ceramic electric stove - 2 burners, microwave with	2.800 €

grill and sink with draining basin.

XL7001	Saloon table, foldable, with high/low and drifting movement	1.950 €
XL7010	Bow table with cover and possibility to convert into sunpad (only with XU1020)	4.400 €
XL7910	Hanging lockers in galley	2.300 €
XL8001	Worktop in galley - MARINE MINERAL STONE (according to colour card)	1.100 €

### UPHOLSTERY & WOOD

XU1001	Upholstery - BALI (according to colour card)	3.400 €
XU1002	Upholstery - CAPETOWN (according to colour card)	3.900 €
XU1003	Upholstery - LIMA (according to colour card)	4.450 €
XU1004	Upholstery - LONG ISLAND LEATHER (according to colour card)	6.350 €
XU1005	Upholstery upgrade in saloon, square stiches design with pillows (according to colour card)	1.850 €
XU1011	Exterior upholstery - SARDINIA (according to colour card)	1.650 €
XU1012	Exterior upholstery - MADEIRA (according to colour card)	1.350 €
XU1013	Exterior upholstery - MALIBU (according to colour card)	1.650 €
XU1020	Bow dinette cushions (according to colour card)	2.800 €
XU1031	Upholstery helmsman seat - LONG ISLAND LEATHER (according to colour card)	1.150 €
XU1110	Comfort mattresses for all berths	3.400 €
XU1500	Carpet in saloon (according to colour card)	3.000 €
XU2020	Cushion with backrest on top of the anchor locker at bow	1.750 €
XU5001	Furniture - ONTARIO OAK (according to colour card)	8.000 €
XU5002	Furniture - SHERWOOD CHESTNUT (according to colour card)	8.550 €
XU5003	Furniture - ATLANTA WALNUT (according to colour card)	7.400 €



XU5100	Furniture - HIGH GLOSS FINISH (only for XU5002 or XU5003)	16.550 €
XU6011	Floorboard in saloon and galley - VENECIAN BLACK WALNUT (according to colour card)	2.200 €
XU6012	Floorboard in saloon and galley - VELVET OAK (according to colour card)	2.800 €
XU6013	Floorboard in saloon and galley - CALIFORNIAN OAK (according to colour card)	2.800 €

### ACCESSORIES

XV1008	Cover for bow cushions (according to colour card)	1.450 €
XV7500	Mosquito nets in fwd hatch	950 €
XV9062	Plisses for saloon and cabins, colour: WHITE, plus blackout blinds in cabins	7.400 €
XV9140	Blinds on sliding door and tilting window	1.150 €
XV9380	Shrink wrap foil (for storage purpose only / not for transport) (not with XA1001, XA1002, XA2001, XA2002)	1.800 €
XV9910	Electronic safe in owner cabin (not with XD5311)	750 €

### TRANSPORT

XZ2001	Loading on truck with disassembled deck parts and antennas	1.450 €
XZ2010	Oversea shipping cradle	4.050 €
XZ2011	IPS Pods removable, loading separated on truck	2.300 €
XZ2020	Ready for pickup	600 €

All mentioned prices in €, basic prices ex yard and excl. VAT. All weights and measures are calculated numbers based on the construction data. Changes in construction and equipment reserved. Above mentioned prices are recommended for ex yard deliveries within 4 month after order confirmation. For later delivery time the company reserves right to apply latest price list. Company reserves additional 15 working days when painted hull or deck is ordered. All measurements/figures are approximate. Errors and omissions excepted. Specification and material can be changed without notice. Valid from 2023.01.01 for deliveries until 2023.12.31.