



## SPECIFICATION & PRICELIST C430

### PRINCIPAL DIMENSIONS according to ISO 8666

Length Overall (Lmax)	13.55 m	44' 5"
Length of Hull (LH)	11.73 m	38' 6"
Beam (BH)	4.20 m	13' 9"
Draught (Tmax)	1.15 m	3' 9"
Air height	4.80 m	15' 9"
Fuel capacity	1100 l	242 UK gal
Water capacity	450 l	99 UK gal
Displacement	13.42 t	13.21 UK t
CE Category - max. pers.	B - 12	C - 14

### ENGINE STANDARD

2 x Volvo Penta IPS500 - Pod drive	30 knots*
------------------------------------	-----------

### ENGINE OPTION

2 x Volvo Penta IPS600 - Pod drive	33 knots*
------------------------------------	-----------



\*All performance figures are given in good faith and are intended as an indication. These figures cannot be guaranteed as top speed in particular is affected by the cleanliness of the hull, conditions of the propellers, weight carried and air/sea temperature. Performance is related also to the optional accessories selected. SEALINE reserves the right to change specifications in line with the company policy of improvement through research and development. Standard Propeller tested in Greifswald according to Volvo conditions. All measurements/figures approximate. Errors and omissions excepted. Specification and material can be changed without notice. Please check with your dealer for a full list of inclusions. \*\*To be confirmed after seatrial. Valid from 2023.01.01 for deliveries until 2023.12.31.

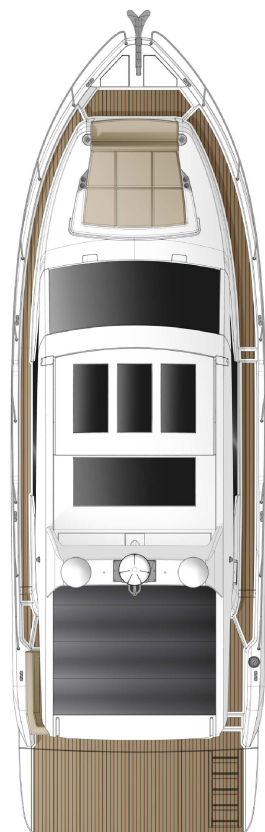

ROOF



MAIN DECK

C1

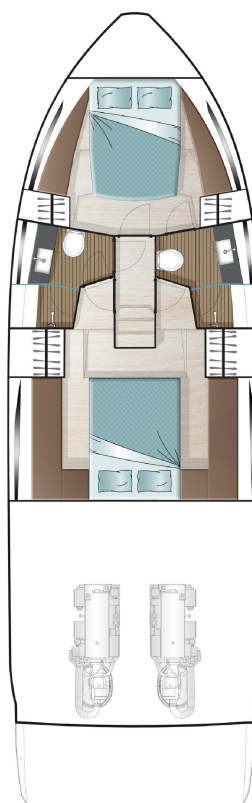

LOWER DECK  
standard

A1

B1

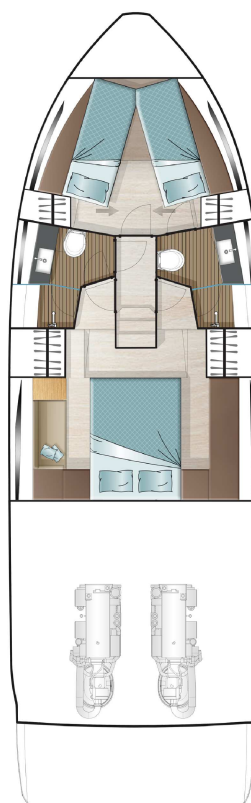

LOWER DECK  
optional

A2

B2

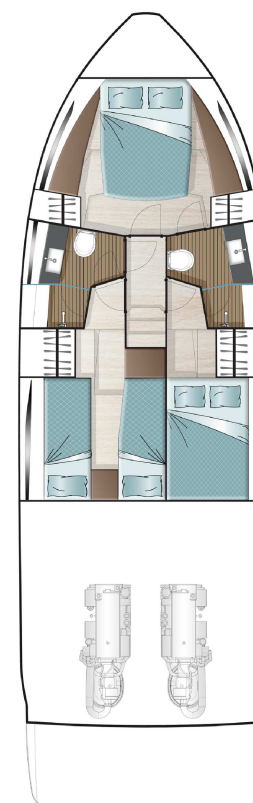

LOWER DECK  
optional

A1

B3

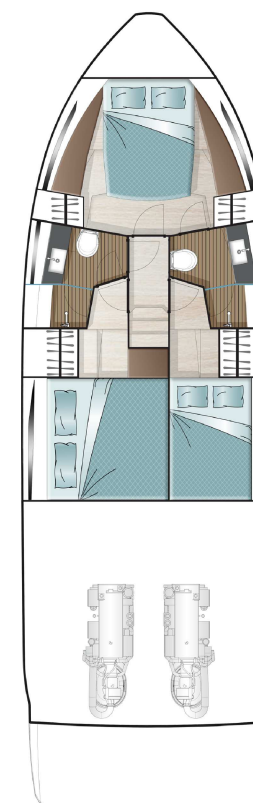

LOWER DECK  
optional

A1

B4

## HULL

- GRP hull with sandwich construction, isophthalic gelcoat, colour: STAR WHITE, 1st layer vinyl ester resin
- Waterline, isophthalic gelcoat, colour: BLACK
- Aft pillar vinyl wrapped in GREY with SEALINE logo
- 2 hull windows (master cabin port side, VIP cabin port side)
- 4 hull windows with openable porthole (master cabin starboard side, VIP cabin, and toilettes)

## DECK & COCKPIT

- GRP deck with antislip surface, isophthalic gelcoat, colour: STAR WHITE, 1st layer vinyl ester resin, anchor locker, self draining, anchor arm stainless steel
- Fender strip, rubber, colour: BLACK
- SEALINE steering wheel and throttles
- Full windscreen with pantograph wipers and screen wash
- Panoramic full glass windows and 2 fixed skylights in saloon
- Sliding door between cockpit and galley and tilting window to enlarge galley into cockpit
- Bathing platform in fiberglass, bathing ladder with handrail and bathing shower with hot and cold water and opening stainless steel gate.
- Stainless steel pulpit, 6 stainless steel mooring cleats, stainless steel handrails
- Seating "L"-shaped bench with fixed backrest with storage underneath and teak bar, manual bimini
- Bench at bow, GRP surface
- Manual engine hatch

## PROPULSION

- Engine room, sound insulated, fans with fire extinguisher system, automatic and manual, Batteries-Engines: 2 x 90 Ah / 12 V, Battery charger 30 A (only for engine batteries)
- 2 Volvo Penta IPS500 (380 hp), Pod Drive propeller: T3, 2 Volvo engine instrumentation

2.5" displays

- Manual TRIM TAB
- Fuel tank, capacity: 1100 litres
- Fuel Filter

## ELECTRICAL EQUIPMENT

- 12 V and 230 V electric system with 230 V shore power connection and digital switches, sockets in saloon (1), master cabin (2), VIP cabin (2), galley (2), toilettes (1), engine room (1) and 12V on dashboard (1)
- Battery set, capacity: 2x 260 Ah
- Country Version: EU / AUS
- Electric toilets
- Light in cabins, saloon and galley with dimmer. Dimmable indirect lights and reading lights in cabins. Lights in toilettes, cockpit and engine room.
- Front screen demister
- Holding tank (170 l)
- Water tank (450 l) with gauge, fresh water pump and boiler (40 l)
- Bilge pumps: automatic electric (2) and manual emergency bilge pump in cockpit (1)

## NAVIGATION & INSTRUMENTS

- Standard dashboard with engine room fire extinguisher system
- Compass

## LAYOUT & INTERIOR

- A1: Bow cabin with double berth, 2 wardrobes and sideboards with stowage and two bedside tables. 1 drawer underneath the bed. 3 Skylights, one openable, direct access to separated head. Fully equipped head with separate shower stall with handheld shower, and comfort seat with wood cover.
- B1: Aft cabin with double berth, wardrobes and sideboards with stowage on both sides, 2 bedside tables, direct access to separated head. Fully equipped head with separate shower stall with handheld shower, and

comfort seat with wood cover. Second door for day head utilization.

- C1: Saloon with "U" shaped sofa, pilot copilot seats, galley with stowage, fridge with freezer compartment, gas stove - 2 burners, 1 gas oven and sink with draining basin
- Saloon table with fixed leg
- Counter tops in galley, in BISTRO material (according to colour card)

## UPHOLSTERY & WOOD

- Upholstery scheme CASABLANCA, colour: PEARL WHITE (according to colour card)
- Exterior seating material in SARDINIA, colour GULL WING (according to colour card)
- Upholstery helmsman seat: CASABLANCA, colour: PEARL WHITE (according to colour card), Bed frames and bedheads in all cabins in soft material, colour: SILVERTEX ANTHRACITE
- Standard mattresses in all cabins
- Carpet for cabins (according to colour card)
- Interior furniture in high quality marine plywood: MADISON WOOD (according to colour card)
- Saloon and galley flooring in AUSTRALIAN ACACIA (according to colour card)

## TRANSPORT

- Identified locations for hand held fire extinguishers - (hand held fire extinguishers are not supplied), SEALINE Owner's Manual in SEALINE document bag

## AS PER STANDARD SPECIFICATION

excl. VAT  
612.200 €

## PROPULSION

XC2001	2 Volvo Penta IPS500 (380 hp) - Pod drive with propeller T4	400 €
XC2006	2 Volvo Penta IPS600 (440 hp) - Pod drive including joystick control with propeller T4	38.350 €
XC4001	Docking Station, 2nd joystick control in cockpit (incl. bowthruster control, when XC6001 selected) (only with XC2006 or XC5000)	6.700 €
XC5000	Joystick for POD drive (only with IPS500 engine)	15.750 €
XC5005	Volvo Penta Dynamic Positioning System (only with XC5011 and XC2006 or XC5000) (not with XN6010)	25.300 €
XC5011	Volvo Penta multifunction 7" display	4.450 €
XC5101	Automatic Interceptor System (HYDROTAB)	4.550 €
XC5201	Double fuel filter with bypass	4.000 €
XC6001	Bowthruster, 8 hp	6.250 €

## PACKAGES

## XW2020 Navigation Package Basic 9.500 €

XN1001	Raymarine i70s multifunctional display with transducer (speed, depth, temp) at helm position
XN1501	Raymarine AXIOM PRO 12 chart plotter at helm position with GPS antenna
XN1602	Enlarged dashboard

## XW2000 Navigation Package 16.400 €

XN1001	Raymarine i70s multifunctional display with transducer (speed, depth, temp) at helm position
--------	--

XN1501	Raymarine AXIOM PRO 12 chart plotter at helm position with GPS antenna
XN1602	Enlarged dashboard
XN2101	Raymarine Ray90 VHF
XN3001	Raymarine Autopilot with control unit at helm position
XN6001	VHF antenna with splitter for FM and AIS

## XW3110 Cruising Package Basic 9.150 €

XB4005	Anchor 20 kg, galvanized with 60 m chain
XB4010	Reversible electric windlass with automatic fuse and remote control at helm position
XB4122	2 additional cleats, 1 at each side
XC7001	Steering wheel, adjustable tilt
XV5001	8 fenders
XV9902	4 mooring lines

## XW3100 Cruising Package 17.150 €

XB4005	Anchor 20 kg, galvanized with 60 m chain
XB4010	Reversible electric windlass with automatic fuse and remote control at helm position
XB4122	2 additional cleats, 1 at each side
XC5101	Automatic Interceptor System (HYDROTAB)
XC7001	Steering wheel, adjustable tilt
XV1000	Cockpit canopies (according to colour card)
XV1007	Outside screen cover (according to colour card)
XV5001	8 fenders
XV9902	4 mooring lines

<b>XW5010</b>	<b>Comfort Package Basic</b>	<b>13.150 €</b>
---------------	------------------------------	-----------------

XB1038	Teak on platform, steps to cockpit and in cockpit
XU1020	Sunbed cushions for foredeck with liftable backrest (according to colour card)
XV7500	Mosquito nets in fwd hatch

<b>XW5011</b>	<b>Upgrade to Comfort Package Basic XW5010 - instead of teak</b>	<b>3.500 €</b>
---------------	--	----------------

XB1039	Synthetic teak on platform, steps to cockpit and in cockpit (according to colour card)
--------	--

<b>XW5000</b>	<b>Comfort Package</b>	<b>20.950 €</b>
---------------	------------------------	-----------------

XA5102	Openable glass porthole in bow cabin on port side
XB1038	Teak on platform, steps to cockpit and in cockpit
XB3111	Saloon opening roof, electric drive with blinds
XU1020	Sunbed cushions for foredeck with liftable backrest (according to colour card)
XV7500	Mosquito nets in fwd hatch

<b>XW5001</b>	<b>Upgrade to Comfort Package XW5000 - instead of teak</b>	<b>3.500 €</b>
---------------	--	----------------

XB1039	Synthetic teak on platform, steps to cockpit and in cockpit (according to colour card)
--------	--

<b>XW5500</b>	<b>Lighting Package</b>	<b>3.000 €</b>
---------------	-------------------------	----------------

XD4001	Courtesy light in the companionway to cabin
XD4023	LED light on side decks
XD4031	2 pop-up-lights at bow

XD4052 Indirect light in saloon, heads and galley

<b>XW6500</b>	<b>Smart Connection Package</b>	<b>2.990 €</b>
---------------	---------------------------------	----------------

XE3110	WLAN router
XN3820	Interior camera

<b>XW7000</b>	<b>Entertainment Package - saloon and cockpit (only with XN6001 or XW2000)</b>	<b>2.800 €</b>
---------------	--	----------------

XE2000	FUSION APOLLO MS-RA770 with AM/FM in saloon
XE2101	4 high-end 2 way speakers in saloon
XE2107	2 high-end 2 way speakers in cockpit
XE2207	FUSION MS-ERX400 remote control in cockpit

<b>XW7001</b>	<b>Entertainment Package - bow cabin (only with XE5110 or XE5111 and XN6001 or XW2000)</b>	<b>3.250 €</b>
---------------	--	----------------

XE2002	FUSION APOLLO MS-RA770 with AM/FM in bow cabin
XE2103	2 high-end 2 way speakers in bow cabin
XE5002	TV flat screen in bow cabin
XE5012	TV preparation in bow cabin

<b>XW7002</b>	<b>Entertainment Package - aft cabin on port side (only with XE5110 or XE5111 and XN6001 or XW2000)</b>	<b>3.250 €</b>
---------------	---	----------------

XE2003	FUSION APOLLO MS-RA770 with AM/FM in aft cabin
XE2104	2 high-end 2 way speakers in aft cabin
XE2115	FUSION MS-AB206 Dual Marine Active Subwoofer in aft cabin
XE5003	TV flat screen in aft cabin
XE5013	TV preparation in aft cabin



<b>XW7003</b>	<b>Entertainment Package - for B1 or B2 Layout (only with XE5110 or XE5111 and XN6001 or XW2000)</b>	<b>3.450 €</b>
---------------	--	----------------

XE2005	FUSION APOLLO MS-RA770 with AM/FM in aft full beam cabin	
XE2106	2 high-end 2 way speakers in aft full beam cabin	
XE2114	FUSION MS-AB206 Dual Marine Active Subwoofer in aft full beam cabin	
XE5005	TV flat screen in aft full beam cabin	
XE5015	TV preparation in aft full beam cabin	

<b>XW7501</b>	<b>TV Package - saloon (only with XE5110 or XE5111)</b>	<b>4.200 €</b>
---------------	---	----------------

XE5001	TV flat screen in saloon	
XE5010	TV preparation in saloon	
XE5051	TV folding system	

# OPTIONS

excl. VAT

## HULL

XA1001	GRP hull, painted, non metallic (according to colour card)	22.450 €
XA1002	GRP hull, painted, metallic (according to colour card)	29.100 €
XA2001	Waterline, painted, non metallic (according to colour card)	1.300 €
XA2002	Waterline, painted, metallic (according to colour card)	1.650 €
XA5114	Openable porthole in full beam cabin (only with layout B1 or B2)	2.250 €
XA5117	Electric openable window on port side in saloon	6.750 €

## DECK & COCKPIT

XB1020	Teak on side decks and bow	9.450 €
XB1021	Synthetic teak on side decks and bow (according to colour card)	9.650 €
XB1505	Hull fender strip in white rubber with stainless steel insert	2.400 €

XB3001	Passerelle, retractable	23.000 €
XB3101	SEALINE convertible fabric roof system in cockpit, electric	5.200 €
XB3212	Saloon door, starboard side	4.050 €
XB3502	High/Low movable bathing platform with retractable ladder	25.300 €
XB4050	Mooring winch at stern on starboard side	2.500 €
XB4110	Anchor chain counter at helm position	990 €
XB4300	Freshwater dockside connection in transom	550 €
XB4310	Freshwater wash down	1.000 €
XB5013	Pilot and copilot seats manual turnable (facing the "U-shaped" sofa and high/low electrically adjustable (not with XU1500 and XB5020)	5.200 €
XB5020	Additional storage room in saloon (not with XB5013)	3.350 €
XB5500	Table in cockpit with fixed leg, cover and electric engine hatch	4.400 €
XB5501	Table in cockpit with high/low leg, cover, sun cushion and electric engine hatch	7.900 €
XB7500	Dinghy Chocks loose on board	900 €

## ELECTRICAL EQUIPMENT

XD1002	Battery set, capacity: 3x 260 Ah	2.590 €
XD1110	Deep charge protection for service batteries	1.390 €
XD1601	Country Version: US / JPN	4.050 €
XD1602	Country Version: UK	1.150 €
XD2001	Inverter/charger with battery management (only with XD1002)	5.150 €
XD2081	10" display for digital switching	2.250 €
XD3001	Fisher Panda generator 10000i, 8.0 kW	18.400 €
XD3101	2nd shore power 230 V or 110 V	1.850 €
XD3215	Toilet with bidet faucet feature in port head	700 €
XD3301	Anti Rolling Gyro (only with XD3001)	51.850 €

XD4012	4 underwater multicolour lights (blue, green, red and white) at stern	4.600 €
XD4013	4 underwater multicolour lights (blue, green, red and white) underneath master cabin hull windows	4.600 €
XD5002	Electric cooktop, 2-rings (only with XD5160) and (only with XD3101 or XD3001 or XD6001 or XD6002)	1.200 €
XD5015	Additional galley refrigerator on starboard side (not with XD5018 or XD5021)	2.100 €
XD5018	Galley freezer on starboard side (not with XD5015 or XD5021)	2.100 €
XD5021	Icemaker on starboard side (not with XD5015 or XD5018)	2.300 €
XD5040	Electric grill, furniture with sink, light and worktop, at stern (only with XD3101 or XD3001 or XD6001 or XD6002)	5.950 €
XD5160	Electric oven with microwave function (only with XD5002)	2.200 €
XD5210	Dishwasher	2.300 €
XD6001	Air conditioning Class E (European) incl. 2nd shore power (only with XD3001)	21.950 €
XD6002	Air conditioning Class G (Gulf) incl. 2nd shore power (only with XD3001)	21.670 €
XD7001	Hot air heating in saloon, cabins and heads	9.950 €
XD8003	Grey-water tank with electric pump for overboard discharge or deck suction	3.700 €

## ENTERTAINMENT

XE5110	Raymarine 45 STV satellite antenna	9.100 €
XE5111	DVB-T2 digital tv antenna	1.050 €

## NAVIGATION &amp; INSTRUMENTS

XN1506	Additional Raymarine AXIOM PRO 12 chart plotter at helm position (only with XW2000 or XW2020)	5.200 €
XN1602	Enlarged dashboard	4.050 €
XN2001	Raymarine Quantum Radar 2 (only with XN2004 and XW2000 or XW2020)	4.200 €
XN2004	Enlarged mast	1.750 €
XN3500	AIS (only with XW2000 or XW2020)	1.750 €
XN3560	MySEALINE Safety Cloud hardware with 30 days free trial subscription and an interior light, switchable by APP	1.490 €
XN3600	Raymarine fishfinder (only with XW2000 or XW2020)	1.800 €
XN3800	Camera aft facing (only with XW2000 or XW2020)	2.190 €
XN3810	Thermal/imaging camera in engine room (only with XW2000 or XW2020)	2.450 €
XN3815	Raymarine ClearCruise Augmented Reality (AR) incl. Gyroscope, GPS antenna and Raymarine IP67 camera installed in the roof (only with XW2000 or XW2020)	2.750 €
XN6001	VHF antenna with splitter for FM and AIS	750 €
XN6010	Satellite empty dome for symmetry	1.750 €
XN9200	Spotlight with remote control (only with XN2004)	900 €

## LAYOUT &amp; INTERIOR

XL1002	A2: Bow cabin with scissor berth, 2 wardrobes, storage and 2 bedside tables. 3 skylights, 1 openable. Direct access to fully equipped head with separated shower stall incl. handheld shower and comfort seat with wood cover.	2.250 €
--------	--	---------

XL2002	B2: Aft cabin with double berth, wardrobes and sideboard on starboard with stowage, 2 bedside tables and vanity area (composed of a table with mirror and seating bench). Direct access to fully equipped head.	3.350 €	XU1012	Exterior upholstery - MADEIRA (according to colour card)	1.200 €
			XU1013	Exterior upholstery - MALIBU (according to colour card)	1.400 €
			XU1031	Upholstery helmsman seat - BALI (according to colour card)	950 €
			XU1032	Upholstery helmsman seat - CAPETOWN (according to colour card)	1.050 €
XL2003	B3: 2 aft cabins. Portside cabin with twin berth, wardrobe, bedside tables and openable porthole. Starboard cabin with double berth, wardrobe and openable porthole. Portside cabin with direct access to heads.	2.900 €	XU1033	Upholstery helmsman seat - LIMA (according to colour card)	1.150 €
			XU1034	Upholstery helmsman seat - LONG ISLAND LEATHER (according to colour card)	1.350 €
			XU1500	Carpet in saloon (according to colour card)	2.500 €
XL2004	B4: 2 aft cabins. Portside cabin with double berth, wardrobe, bedside tables and openable porthole. Starboard cabin with double berth, wardrobe and openable porthole. Portside cabin with direct access to heads.	3.350 €	XU2020	Cushion with backrest on top of the anchor locker at bow (according to colour card)	1.450 €
			XU5001	Furniture - ONTARIO OAK (according to colour card)	5.550 €
			XU5002	Furniture - SHERWOOD CHESTNUT (according to colour card)	6.150 €
XL7001	Saloon table with electric high/low leg which converts into a bed	3.700 €	XU5003	Furniture - ATLANTA WALNUT (according to colour card)	5.100 €
XL7910	Hanging locker for the galley	1.750 €	XU5100	Furniture - HIGH GLOSS FINISH (only for XU5002 or XU5003)	14.250 €
XL8001	Worktop in galley - SPRING WHITE (frames in marine mineral stone, top in HPL - according to colour card)	550 €	XU6011	Floorboard in saloon and galley - VENECIAN BLACK WALNUT (according to colour card)	1.150 €
XL8002	Worktop in galley - MARINE MINERAL STONE (according to colour card)	2.850 €	XU6012	Floorboard in saloon and galley - VELVET OAK (according to colour card)	1.250 €
			XU6013	Floorboard in saloon and galley - CALIFORNIAN OAK (according to colour card)	1.250 €
<b>UPHOLSTERY &amp; WOOD</b>			<b>ACCESSORIES</b>		
XU1001	Upholstery - BALI (according to colour card)	2.250 €	XV1008	Cover for bow cushions (according to colour card)	1.150 €
XU1002	Upholstery - CAPETOWN (according to colour card)	2.750 €	XV2010	Bimini at bow for the sunbed (cushions not included)	3.500 €
XU1003	Upholstery - LIMA (according to colour card)	3.200 €	XV9064	Blinds on sliding door and tilting window	1.150 €
XU1004	Upholstery - LONG ISLAND LEATHER (according to colour card)	5.050 €	XV9104	Plisse for saloon and cabins, colour: WHITE and rollblinds in cabins for blackout	6.850 €
XU1005	Upholstery upgrade in saloon, square stitches design with pillows (according to colour card)	1.250 €			
XU1011	Exterior upholstery - SARDINIA (according to colour card)	1.450 €			



XV9380	Shrink wrap foil (for storage purpose only / not for transport) (not with XA1001, XA1002, XA2001, XA2002)	1.450 €
--------	---	---------

## TRANSPORT

XZ2001	Loading on truck with disassembled deck parts and antennas	1.100 €
XZ2010	Oversea shipping cradle	3.350 €
XZ2011	IPS Pods removable, loading separated on truck	2.300 €
XZ2020	Ready for pickup	600 €

All mentioned prices in €, basic prices ex yard and excl. VAT. All weights and measures are calculated numbers based on the construction data. Changes in construction and equipment reserved. Above mentioned prices are recommended for ex yard deliveries within 4 month after order confirmation. For later delivery time the company reserves right to apply latest price list. Company reserves additional 15 working days when painted hull or deck is ordered. All measurements/figures are approximate. Errors and omissions excepted. Specification and material can be changed without notice. Valid from 2023.01.01 for deliveries until 2023.12.31.