

## SPECIFICATION & PRICELIST C390V

### PRINCIPAL DIMENSIONS according to ISO 8666

Length Overall (Lmax)	12.42 m	40' 9"
Length of Hull (LH)	11.96 m	39' 3"
Beam (BH)	3.85 m	12' 8"
Draught (Tmax)	0.96 m	3' 2"
Air height (DWL)	3.86 m	12' 8"
Fuel capacity	1140 l	250 UK gal
Water capacity	400 l	88 UK gal
Displacement	10.36 t	10.20 UK t
CE Category - max. pers.	B - 10	C - 14

### ENGINE OPTION

2 x Suzuki 350 hp duoprop 32 knots\* TBC



\*Max. outboard horse power: 2x350 hp; max. speed allowed: 40 knots. SEALINE reserves the right to change specifications in line with the company policy of improvement through research and development. All measurements/figures approximate. Errors and omissions are excepted. Specification and material can be changed without notice. Please check with your dealer for a full list of inclusions. Valid from 2023.01.01 for deliveries until 2024.12.31.

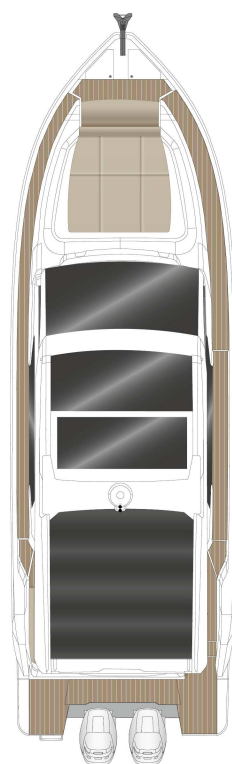

ROOF



MAIN DECK  
standard



MAIN DECK  
optional

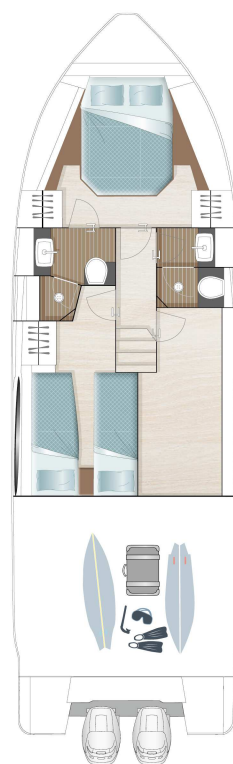

LOWER DECK  
standard

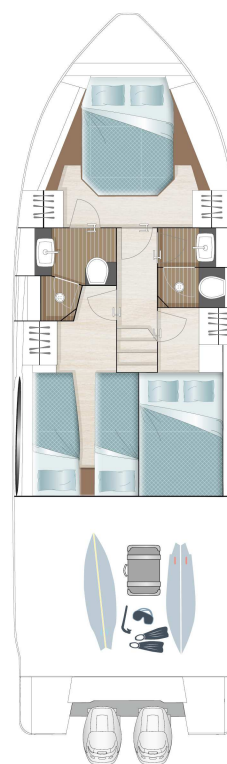

LOWER DECK  
optional

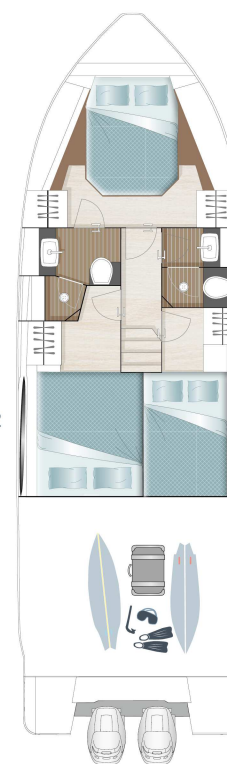

LOWER DECK  
optional

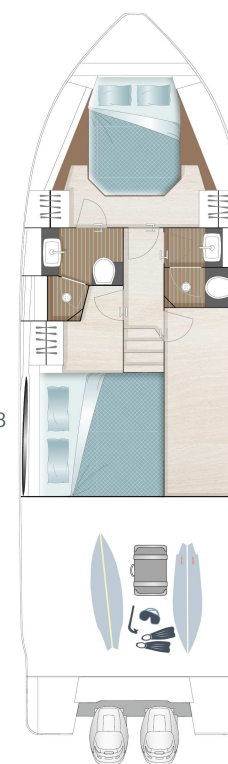

LOWER DECK  
optional

D1

D2

B1

A1

C1

B1

A1

C2

B2

A1

C2

B3

A1

C3

## HULL

- GRP hull, ISO NPG gelcoat, colour: STAR WHITE, 1st layer Vinyl ester resin, sandwich construction, composite structural bulkheads
- Waterline, isophthalic gelcoat, colour: BLACK
- Aft pillar vinyl wrapped in GREY with SEALINE logo
- 1 hull window (master cabin starboard side)
- 4 hull windows with openable porthole (master cabin port side, VIP cabin, and toilettes)

## DECK & COCKPIT

- GRP deck, molded antiskid surface, ISO NPG gelcoat, colour: STAR WHITE, 1st layer vinyl ester resin, sandwich construction, anchor locker, self draining, anchor arm stainless steel
- Fender strip, rubber, colour: BLACK
- SEALINE steering wheel
- Full windscreen with pantograph wipers and screen wash
- SEALINE convertible fabric roof system in cockpit, manual
- Panoramic side full glass windows, skylight in saloon and 2 openable hatches in saloon
- Bifold door between cockpit and galley and tilting window to enlarge galley into cockpit
- 2 side bathing platforms in fiberglass, bathing ladder with handrail and bathing shower with hot and cold water and opening stainless steel gate
- Manual storage hatch in cockpit
- Stainless steel pulpit, 4 stainless steel mooring cleats, stainless steel handrails
- Seating "L"-shaped bench with fixed backrest with storage underneath and teak bar
- Bench at bow, GRP surface

## PROPULSION

- Engine battery preparation including main switches
- Fuel tank, capacity: 1140 litres

## ELECTRICAL EQUIPMENT

- 12 V and 230 V electric system with 230 V shore power connection and switches, sockets in saloon (1), master cabin (2), VIP cabin (1), galley (2), toilettes (2), engine room (1), 12V on dashboard (1) and storage room (1)
- Battery set, capacity: 1x 260 Ah, Service battery charger: 50 A
- Country Version: EU / AUS
- Manual toilets
- Light in cabins, saloon and galley with dimmer. Dimmable indirect lights and reading lights in cabins. Lights in toilettes, cockpit and engine room
- Front screen demister
- Holding tank (170 l)
- Water tank (400 l) with gauge, fresh water pump and boiler (40 l)
- Bilge pumps: automatic electric (2) and manual emergency bilge pump in cockpit (1)

## NAVIGATION & INSTRUMENTS

- Standard dashboard
- Compass
- Navigation lights

## LAYOUT & INTERIOR

- A1: Master cabin with double berth, 2 wardrobes and sideboards with stowage and two bedside tables. 1 drawer underneath the bed. 3 Skylights, one openable, direct access to separated head. Fully equipped head with separated shower stall with skylight, handheld shower, and comfort seat with wood cover.
- B1: VIP cabin with twin berth, wardrobe and sideboard with stowage on port side, skylight
- C1: Storage room and fully equipped day head with separated shower stall, handheld shower and seat on starboard side
- D1: Saloon with "L" shaped sofa, pilot seat, galley with stowage, fridge with freezer compartement, gas stove - 2 burners, 1 gas

oven and sink with draining basin

- Saloon table with fixed leg
- Counter tops in galley, in BISTRO material (according to colour card)

## UPHOLSTERY & WOOD

- Upholstery scheme CASABLANCA, colour: PEARL WHITE (according to colour card)
- Exterior seating material in SARDINIA, colour GULL WING (according to colour card)
- Upholstery helmsman seat: CASABLANCA, colour: PEARL WHITE (according to colour card), Bed frames and bedheads in all cabins in soft material, colour: SILVERTEX ANTHRACITE
- Standard mattresses in all cabins
- Interior furniture in high quality marine plywood: MADISON WOOD (according to colour card)
- Floorboard in saloon, galley and cabins - AUSTRALIAN ACACIA (according to colour card)

## TRANSPORT

- Identified locations for hand held fire extinguishers - (hand held fire extinguishers are not supplied), SEALINE Owner's Manual in SEALINE document bag

## AS PER STANDARD SPECIFICATION

excl. VAT  
343.550 €

## PROPULSION

XC1020	2 engine Suzuki 350 hp duoprop with electrohydraulic lifting jackplates, incl. 2 x digital engine indicator	126.350 €
XC1021	2 engine Suzuki 350 hp duoprop with electrohydraulic lifting jackplates	146.750 €
XC1120	Preparation for engine Suzuki 350 hp duoprop with electrohydraulic lifting jackplates, incl. 2 x digital engine indicator	29.200 €
XC5101	Trim Tabs - manual	2.300 €
XC5105	Automatic control of roll and pitch in the trim tab (only with XC5101)	1.450 €
XC6001	Bowthruster, 8 hp	5.950 €

## PACKAGES

<b>XW2020</b>	<b>Navigation Package Basic</b>	<b>9.500 €</b>
XN1001	Raymarine i70s multifunctional display with transducer (speed, depth, temp) at helm position	
XN1501	Raymarine AXIOM PRO 12 chart plotter at helm position with GPS antenna	
XN1602	Enlarged dashboard	
<b>XW2021</b>	<b>Upgrade to Navigation Package Basic XW2020 - instead of AXIOM PRO 12</b>	<b>3.000 €</b>
XN1502	Raymarine AXIOM XL 16 chart plotter at helm position with GPS antenna	

**XW2000 Navigation Package 12.300 €**

XN1001	Raymarine i70s multifunctional display with transducer (speed, depth, temp) at helm position
XN1501	Raymarine AXIOM PRO 12 chart plotter at helm position with GPS antenna
XN1602	Enlarged dashboard
XN2101	Raymarine Ray90 VHF
XN6001	VHF antenna with splitter for FM and AIS

**XW2010 Upgrade to Navigation Package XW2000 - instead of AXIOM PRO 12 3.000 €**

XN1502	Raymarine AXIOM XL 16 chart plotter at helm position with GPS antenna
--------	---

**XW3110 Cruising Package Basic 8.000 €**

XB4005	Anchor 16 kg, galvanized with 60 m chain
XB4010	Reversible electric windlass with automatic fuse and remote control at helm position
XB4122	4 additional cleats, 2 at each side
XC7001	Steering wheel, adjustable tilt
XV5001	8 fenders
XV9902	4 mooring lines

**XW3100 Cruising Package 12.000 €**

XB4005	Anchor 16 kg, galvanized with 60 m chain
XB4010	Reversible electric windlass with automatic fuse and remote control at helm position

XB4122	4 additional cleats, 2 at each side
XC7001	Steering wheel, adjustable tilt
XV1000	Cockpit canopies (according to colour card)
XV5001	8 fenders
XV9902	4 mooring lines

<b>XW5010</b>	<b>Comfort Package Basic</b>	<b>13.150 €</b>
---------------	------------------------------	-----------------

XB1038	Teak on platform, steps to cockpit and in cockpit
XD3202	Electrical toilet - on starboard side
XD3204	Electrical toilet - on port side
XU1020	Sunbed cushions for foredeck with liftable backrest (according to colour card)
XV7500	Mosquito nets in fwd hatch
XV9060	Blinds for hull windows
XV9061	Blinds for hatches

<b>XW5011</b>	<b>Upgrade to Comfort Package Basic XW5010 - instead of teak</b>	<b>2.300 €</b>
---------------	--	----------------

XB1039	Synthetic teak on platform, steps to cockpit and in cockpit (according to colour card)
--------	--

<b>XW5000</b>	<b>Comfort Package</b>	<b>20.950 €</b>
---------------	------------------------	-----------------

XA5105	Openable glass porthole in master cabin on starboard side
XB1038	Teak on platform, steps to cockpit and in cockpit
XB3111	Saloon opening roof, electric drive with blinds
XD3202	Electrical toilet - on starboard side
XD3204	Electrical toilet - on port side
XU1020	Sunbed cushions for foredeck with liftable backrest (according to colour card)

XV7500	Mosquito nets in fwd hatch
XV9060	Blinds for hull windows
XV9061	Blinds for hatches

<b>XW5001</b>	<b>Upgrade to Comfort Package XW5000 - instead of teak</b>	<b>2.300 €</b>
---------------	--	----------------

XB1039	Synthetic teak on platform, steps to cockpit and in cockpit (according to colour card)
--------	--

<b>XW5500</b>	<b>Lighting and Charging Package</b>	<b>3.000 €</b>
---------------	--------------------------------------	----------------

XD2070	Wireless mobile charging in owner cabin (2) and saloon (1)
XD4001	Courtesy light in the companionway to cabin
XD4023	LED light on side decks
XD4052	Indirect light in saloon, heads and galley

<b>XW6500</b>	<b>Smart Connection Package</b>	<b>2.990 €</b>
---------------	---------------------------------	----------------

XE3110	WLAN router
XN3820	Interior camera

<b>XW7000</b>	<b>Entertainment Package - saloon and cockpit (only with XN6001 or XW2000)</b>	<b>2.800 €</b>
---------------	--	----------------

XE2000	FUSION APOLLO MS-RA770 with AM/FM in saloon
XE2101	2 high-end 2 way speakers in saloon
XE2107	2 high-end 2 way speakers in cockpit
XE2207	FUSION MS-ERX400 remote control in cockpit

<b>XW7001</b>	<b>Entertainment Package - master cabin (only with XE5111 and XN6001 or XW2000)</b>	<b>3.250 €</b>
---------------	---	----------------

XE2005	FUSION APOLLO MS-RA770 with AM/FM in master cabin
--------	---



XE2106	2 high-end 2 way speakers in master cabin	
XE5005	TV flat screen in master cabin	
XE5015	TV preparation in master cabin	

<b>XW7002</b>	<b>Entertainment Package - VIP cabin on port side (only with XN6001 or XW2000)</b>	<b>1.850 €</b>
---------------	--	----------------

XE2004	FUSION APOLLO MS-RA770 with AM/FM in VIP cabin	
XE2105	2 high-end 2 way speakers in VIP cabin	

<b>XW7501</b>	<b>TV Package - saloon (only with XE5111)</b>	<b>2.300 €</b>
---------------	---	----------------

XE5001	TV flat screen in saloon	
XE5010	TV preparation in saloon	
XE5051	TV bracket	

<b>OPTIONS</b>	<b>excl. VAT</b>
----------------	------------------

<b>HULL</b>
-------------

XA1001	GRP hull, painted, non metallic (according to colour card)	17.650 €
XA1002	GRP hull, painted, metallic (according to colour card)	23.700 €
XA2001	Waterline, painted, non metallic (according to colour card)	1.200 €
XA2002	Waterline, painted, metallic (according to colour card)	1.450 €
XA5103	Window with porthole in glass in utility room (only with C1 layout or XL3003)	3.350 €
XA5108	Electric openable window on port side in saloon	5.650 €

<b>DECK &amp; COCKPIT</b>
---------------------------

XB1020	Teak on side decks and bow	8.700 €
XB1021	Synthetic teak on side decks and bow (according to colour card)	8.900 €
XB1505	Hull fender strip in white rubber with stainless steel insert	2.300 €

XB3101	SEALINE convertible fabric roof system in cockpit, electric	6.850 €
XB3212	Saloon door, starboard side	4.500 €
XB3610	Electric openable storage hatch in cockpit	1.150 €
XB3640	Fiberglass box in storage underneath cockpit	4.850 €
XB4110	Anchor chain counter at helm position	990 €
XB4300	Freshwater dockside connection in transom	550 €
XB4310	Freshwater wash down	1.000 €
XB5011	Foldable copilot seat port side (only with XL7001)	1.750 €
XB5101	Convertible aft backrests lower and raise (electric) in cockpit	3.400 €
XB5500	Cockpit table foldable with fixed leg and cover (only with XB3610)	3.000 €
XB5501	Cockpit table foldable with high/low leg, sun cushion and cover (only with XB3610)	4.900 €
XB7500	Dinghy Chocks loose on board	900 €

<b>ELECTRICAL EQUIPMENT</b>
-----------------------------

XD1002	Battery set, capacity: 2x 260 Ah with 50 Ah Battery charger	1.750 €
XD1110	Deep charge protection for service batteries	1.390 €
XD1601	Country Version: US / JPN	4.050 €
XD1602	Country Version: UK	1.050 €
XD2001	Inverter/charger with battery management (only with XD1002)	5.150 €
XD3001	Fisher Panda generator 10.000i, 8.0 kW	17.200 €
XD3101	2nd shore power 230 V or 110 V	1.850 €
XD3301	Anti Rolling Gyro (only with XD3001)	46.100 €
XD4012	4 underwater multicolour lights (blue, green, red and white) at stern	4.600 €
XD5002	Electric cooktop, 2-rings (only with XD5150) and (only with XD3001 or XD3101 or XD6001 or XD6002)	1.200 €
XD5014	Additional fridge and locker in utility room (only with C1 Layout or XL3003)	2.300 €

XD5150	Microwave with grill (not with standard gas oven - only with XD5002)	900 €
XD6001	Air conditioning Class E (European) incl. 2nd shore power (only with XD3001)	19.700 €
XD6002	Air conditioning Class G (Gulf) incl. 2nd shore power (only with XD3001)	21.800 €
XD7001	Hot air heating in saloon, cabins and heads	6.900 €
XD8003	Grey-water tank with electric pump for overboard discharge or deck suction	3.350 €

#### ENTERTAINMENT

XE5111	DVB-T2 digital tv antenna	1.050 €
--------	---------------------------	---------

#### NAVIGATION & INSTRUMENTS

XN1602	Enlarged dashboard	3.450 €
XN2001	Raymarine Quantum Radar 2 (only with XN2020 and XW2000 or XW2010 or XW2020 or XW2021)	4.200 €
XN2020	Enlarged mast	500 €
XN3500	AIS (only with XW2000 or XW2010 or XW2020 or XW2021)	1.750 €
XN3560	MySEALINE Safety Cloud hardware with 30 days free trial subscription and an interior light, switchable by APP	1.290 €
XN3600	Raymarine fishfinder (only with XW2000 or XW2010 or XW2020 or XW2021)	1.800 €
XN3800	Camera aft facing (only with XW2000 or XW2010 or XW2020 or XW2021)	2.190 €
XN3815	Raymarine ClearCruise Augmented Reality (AR) incl. Gyroscope, GPS antenna and Raymarine IP67 camera installed in the roof (only with XW2000 or XW2010 or XW2020 or XW2021)	2.750 €

XN6001	VHF antenna with splitter for FM and AIS	750 €
XN9200	Spotlight with remote control (only with XN2020)	900 €

#### LAYOUT & INTERIOR

XL2002	B2: VIP cabin with double berth, wardrobe and sideboard with stowage on port side (not with XL3003)	1.150 €
XL2003	B3: Aft cabin with longitudinal double berth, wardrobe and sideboard with stowage on port side (only with XL3003)	1.200 €
XL3002	C2: Guest cabin with double berth, wardrobe and fully equipped day head with separated shower stall on starboard side, window with openable porthole (only with B1 layout or XL2002)	3.100 €
XL3003	C3: Storage room and fully equipped day head with separated shower stall, handheld shower and seat on starboard side (only with XL2003)	200 €
XL4002	D2: Additional slidable seat in saloon with drawer fridge underneath, galley with stowage, fridge with freezer compartment, gas stove - 2 burners, 1 gas oven and sink with draining basin	3.700 €
XL7001	Saloon table foldable with fixed leg	900 €
XL8001	Worktop in galley - SPRING WHITE (frames in marine mineral stone, top in HPL - according to colour card)	550 €

#### UPHOLSTERY & WOOD

XU1001	Upholstery - BALI (according to colour card)	1.700 €
XU1002	Upholstery - CAPETOWN (according to colour card)	1.900 €
XU1003	Upholstery - LIMA (according to colour card)	2.150 €
XU1004	Upholstery - LONG ISLAND LEATHER (according to colour card)	4.450 €
XU1005	Upholstery upgrade in saloon, with pillows (according to colour card)	1.250 €

XU1011	Exterior upholstery - SARDINIA (according to colour card)	970 €
XU1012	Exterior upholstery - MADEIRA (according to colour card)	800 €
XU1013	Exterior upholstery - MALIBU (according to colour card)	1.000 €
XU1031	Upholstery helmsman seat - BALI (according to colour card)	800 €
XU1032	Upholstery helmsman seat - CAPETOWN (according to colour card)	950 €
XU1033	Upholstery helmsman seat - LIMA (according to colour card)	1.050 €
XU1034	Upholstery helmsman seat - LONG ISLAND LEATHER (according to colour card)	1.250 €
XU1500	Carpet in saloon (according to colour card)	2.250 €
XU1510	Carpet in cabins (according to colour card)	2.450 €
XU5001	Furniture - ONTARIO OAK (according to colour card)	5.100 €
XU5002	Furniture - SHERWOOD CHESTNUT (according to colour card)	5.650 €
XU5003	Furniture - ATLANTA WALNUT (according to colour card)	4.600 €
XU5100	Furniture - HIGH GLOSS FINISH (only for XU5002 or XU5003)	10.300 €
XU6011	Floorboard in saloon, galley and cabins - VENECIAN BLACK WALNUT (according to colour card)	1.150 €
XU6012	Floorboard in saloon, galley and cabins - VELVET OAK (according to colour card)	1.250 €
XU6013	Floorboard in saloon, galley and cabins - CALIFORNIAN OAK (according to colour card)	1.250 €

## ACCESSORIES

XV1007	Outside screen cover, front and side triangle screen (according to colour card)	2.300 €
XV1008	Cover for bow cushions (according to colour card)	1.150 €
XV2010	Bimini at bow for the sunbed (cushions not included)	3.100 €
XV9100	Plisse on sliding door and tilting window	1.150 €

XV9104	Plisse for saloon	4.500 €
XV9380	Shrink wrap foil (for storage purpose only / not for transport) (not with XA1001, XA1002, XA2001, XA2002)	1.100 €

## TRANSPORT

XZ2001	Loading on truck with disassembled deck parts and antennas	900 €
XZ2010	Oversea shipping cradle	3.350 €
XZ2020	Ready for pickup	600 €

All mentioned prices in €, basic prices ex yard and excl. VAT. All weights and measures are calculated numbers based on the construction data. Changes in construction and equipment reserved. Above mentioned prices are recommended for ex yard deliveries within 4 month after order confirmation. For later delivery time the company reserves right to apply latest price list. Company reserves additional 15 working days when painted hull or deck is ordered. All measurements/figures are approximate. Errors and omissions excepted. Specification and material can be changed without notice. Valid from 2023.01.01 for deliveries until 2024.12.31.